



**FACULTY OF SOCIAL WORK  
THE M.S. UNIVERSITY OF BARODA**

Ph.D. Scholar  
Saroj Vardiwale

Ph.D. Guide  
Prof. Chhaya Patel

APPENDIX – I : INTERVIEW SCHEDULE

INFORMATION ABOUT R-R SITE

1. R-R Site : \_\_\_\_\_  
Taluka : \_\_\_\_\_ District : \_\_\_\_\_  
Host village : \_\_\_\_\_
2. Year of establishment : \_\_\_\_\_
3. Number of PAFs in the site :  
On Record : \_\_\_\_\_ Actual Number : \_\_\_\_\_

4. Submergence village of PAFs :

Sr.No.	Submergence Village	No. of PAFs
1		
2		
3		
4		
5		

5. Social groups (Tribes) at R-R site :

Sr.No.	Tribe	No. of PAFs
1		
2		
3		
4		
5		

6. Distance of agricultural cooperative from R-R site (if any) : \_\_\_\_\_
7. Number of PAFs availing its benefit : \_\_\_\_\_
8. Nearby milk cooperative (if any) :  
Name : \_\_\_\_\_  
Distance from R-R site : \_\_\_\_\_
9. Number of member PAFs in milk cooperative : \_\_\_\_\_

10. Occupation of PAFs in R-R site :
  - a) Agriculture :
  - b) Agriculture labour :
  - c) Government service :
  - d) G.I.D.C.
  - e) Others
11. Activities of vasahat samiti :
12. Number of PAFs elected in Panchayat

**FACULTY OF SOCIAL WORK  
THE M.S.UNIVERSITY OF BARODA**

Ph.D. Scholar  
Saroj Vardiwale

Ph.D. Guide  
Prof.Chhaya Patel

---

**APPENDIX - II**

**KEY INFORMANTS (SARPANCH / VASAHAT)**

- (I)    Name :  
      Age :                      Education :                      R-R Site :  
      Taluka :                      Dist :                      .
- 1)    All PAFs have title                      Yes                      No                      Other  
      to cultivable land in the site
- 2)    There is no landlessness                      Yes                      No                      Other
- 3)    Crop yields improved                      Yes                      No                      Other
- 4)    PAFs find difficult to adjust    Yes                      No                      Other  
      with agricultural cycle,  
      method & type of crops  
      grown in site
- 5)    In what way do you contribute in the process of resettlement?
- 6)    Do you feel, you can still contribute as a well wisher of the people?  
      In what way?
- (II)    People's Participation :
- 7)    Your view about people's participation as a -  
      A) Social Utit –
- a) Occasions  
      b) Mode of participation (cash / kind / grains / fuel wood / other)  
      c) Frequency of participation in a year  
      d) Participants (men, women, teenagers, etc.)

- 8) Your view about infrastructural facilities at site  
(road, transport, communication, civic amenities) daily groceries and services etc. availability, accessibility, utilization)
- 9) Your view about people's adjustment and reintegration potential  
(adapting language, clothes, employment, market economy, lending borrowing, participation local organizations, youth / mahila mandal, formation of any organization at site; overall perception of R-R induced changes on the part of PAFs)
- (1) Language
  - (2) Costumes (clothing)
  - (3) Employment / Income generation activity
  - (4) Market
  - (5) Lending borrowing
  - (6) Participation in local organization  
(yuvak mandal / mahila mandal / bhajan mandal / others)
  - (7) Political participation
  - (8) Overall feelings of people towards changes due to R-R

**FACULTY OF SOCIAL WORK  
THE M.S.UNIVERSITY OF BARODA**

Ph.D. Scholar  
Saroj Vardiwale

Ph.D. Guide  
Prof.Chhaya Patel

---

**APPENDIX – III**

**PSYCHO-SOCIAL STUDY OF PROJECT AFFECTED FAMILIES  
OF SARDAR SAROVAR PROJECT (GUJARAT)**

**(I) Personal Information :**

1. Name
2. Sex
3. Age
4. Address
5. Education
6. Tribe :  
Tadavi                      Vasava                      Dungari Bhil  
Rathawa                      Nayaka                      Other                      (specify)
7. Occupation :  

Government Employee	Agriculture
Small Farmers	Marginal Farmers
Medium Farmers	Agricultural Labourer
Construction Labour	Self Employment
Mixed	Other                      (specify)
8. Duration of stay in resettlement site :  

Less than 5 years	6-10 years
More than 10 years	

**(II) R and R (Resettlement and Rehabilitation) Process :**

- Preshift process
- During shift
- Post-shift

(II)(A) Preshift Process :

9. Were you consulted prior to the shift?  
Yes                      No                      Neutral
10. Was assessment / survey of land, house and other assets done?  
Yes                      No                      Neutral
11. Were compensation notices issued and amount fixed?  
Yes                      No                      Neutral
12. Is the compensation adequate?  
Yes                      No                      Neutral
13. Was the compensation given in time?  
Yes                      No                      Neutral
14. Please narrate difficulties / problem prior shift.

(II)(B) During Shift process :

15. State the facilities experienced during shift process.
16. State the difficulties faced during shift process.
17. What was government approach during shift?
18. How did you feel when you were asked to shift?
- |            |         |      |
|------------|---------|------|
| Confusion  | Anxiety | Fear |
| Insecurity | Other   |      |
19. How did you wife react?
20. How did your parents react?
21. How did community react to it?

(III) Post-shift Process :

(III) (A) Material wellbeing (land, income, food, clothing, housing and environment, land)

(A)1. Land :

22. Did every eligible member in family get land as per entitlement?  
Yes                      No

23. Land is beneficial because
- 1.
  - 2.
  - 3.
  - 4.
- Land is not beneficial because
- 1.
  - 2.
  - 3.
  - 4.
24. State it's effect on livestock.
25. Suggestions
- (A)2 Economic condition :
26. Farm economy at R-R site improved.  
Yes                      No                      Neutral
27. Are employment opportunities available?  
Yes                      No                      Neutral
28. Has overall income increased?  
Yes                      No                      Neutral
29. Has indebtedness increased?  
Yes                      No                      Neutral
30. Are loans to be availed?  
Yes                      No
31. Purposes for seeking loans – agricultural / social / health / education / business / others
32. State the rate of interest.
33. Difficulties in availing loan, if any :
34. Is there increase in food expenditure?  
Yes                      No                      Neutral



35. Is there increase in expenditure towards health?  
Yes                      No                      Neutral
36. Is there increase in expenditure towards education?  
Yes                      No                      Neutral
37. Has your saving potential has increased?  
Yes                      No                      Neutral
38. Did you get training for employment purpose, if any (vocational training) imparted by NGO / SSPA / Govt. department – DRDA, Panchayat etc.  
Yes                      No                      Neutral

(A)3. Health

39. Access to health care facility is easier / manageable / difficult / not possible  
(distance between residence and health care facility \_\_\_\_\_ km)

40. Frequency of illness among -

	Increased	Same	Reduced
Children			
Women			
Men			

41. Type/s of illness among -  
Children  
Women  
Men

42. Your experience of available health care facility :

43. Whom do you approach for treatment when ill? Why?

(A)4. Education :

44. What is the distance between R-R site and school?

45. Are you able to access educational facility better than before?  
Yes                      No                      Neutral

46. Does the school function regularly?  
Yes                      No                      Neutral

47. Are teachers attentive to learning needs of the children?  
Yes                      No                      Neutral

48. Difficulties relating with education of children.

- a) Language
- b) Method of teaching
- c) Content / Syllabus
- d) Any other

(A)5. Food and Nutrition :

49. Food contents in daily meal :

50. What change in food items is made, if any :

51. Have you changed your cooking practices, if any :

52. Difficulties you have faced while adopting new dietary habits and cooking practices.

53. How did you managed it?

54. Grain storage facility.

(A)6. Water facility :

55. Sources of water are -

- Taps
- Hand pumps
- Wells
- Any other

56. What are your experiences with available water facility (time, frequency, distance, regularity, charges, etc.)

- Time
- Frequency
- Distance
- Regularity
- Charges
- Any other

57. Difficulties associated with it, if any.

58. How do you overcome those difficulties?

(A)7. Clothing style :

59. Clothing pattern for -  
Women  
Men

60. Your response to changed clothing pattern (liking, suitable cost, etc.)

(A)8. Housing and environment :

61. Your view about your house (in terms of size, ventilation, facilities, facilities for domestic animals, if any etc.)

62. Your experience with the same (emotional aspect, appropriateness regarding domestic work, cattle rearing, etc.)

63. Difficulties associated with the same.

64. How did you manage it? (physical and emotional efforts)

(III)B. Quality of family life :

65. What is the change in family's structure?

67. Your view about your family at the site :

- Compensation
- Interaction / communication
- Emotional bonding
- Role performance and difficulties

Satisfied      Not satisfied      Don't know      Difficulty

- a) as a son
- b) as a husband
- c) as a father/mother
- d) Other role/s

68. State change in family's functioning (if any) :

69. Experiences and views of other family members regarding quality of family life at the site.

- Parents
- Wife
- Children
- Others

70. Is life full of difficulties and problems  
Agree / Disagree / Undecided
71. You feel tired both – physically and mentally
72. You face tensions and strains
73. You feel happy with own family members.
74. Your family members feel happy to live together.
75. You feel you are getting alienated from my family.
76. Complaints by family members, if any
- (III)C Quality of Social Life : (PAFs – PAFs, PAFs & Host village at site;  
PAFs – PAFs at different sites)
77. Tribes (social group)
- At site :
- Host village :
78. Your view of relationship among PAFs in same vasahat (site) :
- Cooperation
  - Lending
  - Borrowing
  - Participation in celebrations
  - Festival celebration
  - Emergencies
  - Customs – traditions
  - Others
79. Difficulties faced :
80. Your efforts to overcome those difficulties.
81. Your view of relationship among PAFs in different sites.
82. Difficulties faced
83. Efforts to overcome the same

84. Your view about relationships between PAFs and host village.
- Interaction – frequency
  - Reasons
  - Content of interaction
  - Outcome
85. Difficulties / problems faced during interaction (hostility, stealings, shortage, tensions etc.)
86. How do you manage / overcome it?
87. Do you feel that bonding among traditional social groups has -  
Improved                      Remained same                      Reduced
88. Do you feel that social hierarchies have -  
Continued                      Diluted                      Broken
- (IV) Religion :
89. Do you feel religious rites and beliefs are threatened?  
Always                      Most of times                      Sometimes                      Never
90. Do you find rituals difficult in absence of mahuda trees at sites?  
Always                      Most of times                      Sometimes                      Never
91. Do you visit hills to collect mahuda to perform rituals?  
Always                      Most of times                      Sometimes                      Never
92. Do Hamlets recognize village God? (Pantheon)  
Always                      Most of times                      Sometimes                      Never
- (V) Infrastructure Facilities :
93. Approach road is needed?
94. Approach road is constructed?
95. Is it pucca?
96. Bus frequency is adequate.

97. R&R site has cooperative societies?  
 Yes                      No
- Which type?  
 Milk Coop.                      Credit Co-op.                      Milk collection centre                      Other
98. Daily groceries and services (tailoring / hair cutting / smithies / flour mill etc.)  
 Are easily accessible                      At manageable distance  
 Far off
- How far?                      1-3 kms                      3-5 kms                      Beyond 5 kms.
99. Electricity facility is -  
 Better                      Same                      Worsened
100. Drainage facility is -  
 Better                      Same                      Worsened
101. It is -  
 Easier                      Difficult
- to communicate with other relatives during emergency.
102. Telephone booth is -  
 Nearer                      Far off
103. Telephone works for -  
 24 hours                      Only for few hours                      Out of order
104. Please state difficulty / problem faced, if any.

(VI) Rehabilitation Potential Scale :

105. My family members feel closely attached to one another.  
 Yes                      No                      Other
106. I consider my family, a source of help to most of the problems.  
 Yes                      No                      Other
107. I feel confident that relatives and friends will help me during difficulties.  
 Yes                      No                      Other
108. I feel joyful of being part of this site.  
 Yes                      No                      Other

109. I feel I can manage situation even when they don't turnout as expected
110. I feel confident in coping with the future demands.  
Yes                      No                      Other
111. I don't get disappointed with the common worries of daily life.  
Yes                      No                      Other
112. Compared with the past, I feel the present life is better.  
Yes                      No                      Other
113. I feel, I have achieved the standard of living.  
Yes                      No                      Other
114. I feel, I have achieved expected social status.  
Yes                      No                      Other
115. I feel my life is interesting.  
Yes                      No                      Other
116. I feel, I am satisfied with most of the aspects of my life.  
Yes                      No                      Other
117. I feel that efforts and capabilities to improve situation after resettlement have been successful.  
Yes                      No                      Other
118. I feel that intimacy with community is strengthened.  
Yes                      No                      Other
119. I fully cooperate in important functions of my community.  
Yes                      No                      Other
120. Suggestions :
- 1.
  - 2.
  - 3.
  - 4.
  - 5.

(IV)

#### An Overview of R&R Policy At SSP

Sr. No.	Item	NWDT Award	Madhya Pradesh	Gujarat	Maharashtra
1.	Definition of oustee	An oustee shall mean any person who, since at least one year prior to the date of publication of notification u/s 4 of the Land Acquisition Act, has been ordinarily residing or cultivating land or carrying on any trade, occupation or calling or working for gain in the area likely to be submerged permanently or temporarily.	Any person who has been ordinarily. Residing or carrying on any trade or vacation for his livelihood for atleast one year before the date of publication of notification u/s 4 of the Land Acquisition Act or has been cultivating land for at least three years prior to such notification in an area which is likely to come under submergence whether temporarily or permanently because of the project or is otherwise required for the Project.	Same as under NWDT Award Clause XI-1(2)	Same as under NWDT Award Clause XI-1(2)
2.	Family	A family shall include husband, wife and minor children and	A family shall mean and include husband, wife and minor children	Same as under NWDT Award Clause XI-1(3) (ii)	Same as under NWDT Award Clause XI-1(3) (ii)

Rehabilitation is Possible



Sr. No.	Item	NWDT Award	Madhya Pradesh	Gujarat	Maharashtra
		other persons dependent on the head of the family, e.g. widowed mother.	and other persons dependent on the head of the family e.g. widowed mother, widowed sister, unmarried sister, unmarried daughter of old father.		
3.	LAND ALLOTMENT (a) Landed Oustees	Every displaced family from whom more than 25% of its land holding is acquired shall be entitled of and be allotted irrigable land to the extent of land acquired from it subject to the prescribed ceiling in the State concerned and a minimum of 2 hectares (5 acres) per family, the irrigation facilities being provided by the State in whose territory the allotted land is situated. This land shall be transferred to	1. Land equivalent to that acquired with a minimum of 2 ha. and maximum of 8 ha. and also Govt. assistance in providing irrigation by wells/ tubewells or any other method if land not irrigated,. If irrigation is not possible, minimum 4 ha. Will be allotted. Development of dry land would be subsidized by the Government to the extent of 75% of the cost involved.	1. Land equivalent to the acquired with a minimum of 2 ha. and maximum limited to State ceiling. Joint holders are also eligible for land equal to his share subject to a min. of 2 ha. Joint holders and major sons will be considered as co-share of acquired land. Irrigation facilities to be provided by the State.	1. Land equivalent to that acquired with a minimum of 2 ha. And maximum limited to State ceiling. Joint holders are also eligible for land equal to his share subject to a minimum of 2 ha. Irrigation facility to be provided by the State.

Sr. No.	Item	NWDT Award	Madhya Pradesh	Gujarat	Maharashtra
		the oustee family if it agrees to take it. The price charged for it would be as mutually agreed between Gujarat and the concerned State. Of the price to be paid for the land a sum equal to 50% of the oustee family for the land acquired from it will be set off as an initial installment of payment. The balance cost of the allotted land shall be recovered from the allot in 20 yearly installments free of interest. Where land is allotted in Madhya Pradesh or Maharashtra, all recoveries for the allotted land shall be credited to Gujarat.	2.(a) For families of all SC/ST and other categories with land holding up to 2 ha. grant, in-aid would be paid to cover the gap, if any, between the amount of compensation and the cost of allotted land in full. For other owning land from 2 to 8 ha. Will be eligible for an additional amount of Rs. 2000/- per ha. of 50% of the difference in cost of allotted land and the compensation received whichever is less. (b) Oustee has two choice: 1. He can opt for cash compen-	2. Where agriculture land is purchased by the oustees' family through committee the difference, if any, in price of land so purchased and the amount of compensation shall be paid as an ex-gratia." 3. The landed oustee/encroacher who have received compensation of land has an option to contribute 50% of his compensation as initial installment towards the cost of allotted land and rest of the amount of the cost of land to be repaid in 20	2. The land is allotted to the oustee free of cost.

Sr. No.	Item	NWDT Award	Madhya Pradesh	Gujarat	Maharashtra
			<p>sation for his submerged land.</p> <p>II. He can opt for compensation in the form of land. He will be entitled for 50% amount of compensation in cash and remaining 50% amount will be adjusted against the cost of the allotted land. Remaining cost of allotted land will be recovered in 20 yearly installments as loan due from third year. Loan will be interest free.</p>	<p>years, yearly interest free installments of contribute 100% compensation towards the cost of allotted land and the difference between the price of the allotted land and compensation would be treated as ex-gratia towards occupancy price. In other categories, i.e. landless agricultural labourer, encroacher (who has not received compensation) and their major sons are given full ex-gratia amount towards the cost of allotted land.</p>	

<b>Sr. No.</b>	<b>Item</b>	<b>NWDT Award</b>	<b>Madhya Pradesh</b>	<b>Gujarat</b>	<b>Maharashtra</b>
(b)	Encroacher oustees	No land allotment benefit provided	<p>(a) They will be treated as landed oustees subject to two conditions.</p> <p>(i) Encroachment must be on or before 13.4.87.</p> <p>(ii) Allotment of agricultural land will be 1 ha. or 2 ha. Only subject to the size of encroachment coming under submergence.</p> <p>(b) Encroachers will be entitled to get compensation for land under submergence.</p>	Encroachers prior to 1 year of Notification under Sec. 4 of the Act are entitled for 2 ha. of land and compensation for the balance encroached land as ex-gratia	2 ha. of land and compensation as ex-gratia payment for the balance land encroached up to 31/3/78. Later encroachers will be treated as land less and will get 1 ha. Agriculture land.
(c)	Land less oustees	No provision for land allotment	No. land. All landless agricultural labourers and all SC/ST landless oustees will get	2 ha. of land to landless Agricultural labourers only.	1 ha. Of land if oustee moves with others.

Sr. No.	Item	NWDT Award	Madhya Pradesh	Gujarat	Maharashtra
			Rs.29000 each for productive assets while other landless will get Rs. 19500 accordingly.		
(d)	Major sons of above all categories of oustees	<ul style="list-style-type: none"> <li>Every major sons will treated as separate family</li> <li>No provision for land allotment</li> </ul>	Major sons will be treated as separate family. They will be entitled to cash compensation according to the category to which they belong.	2 ha of land to each major sons of all category of oustees with 1/1/87 as cut-off date for major sons.	1 ha. Of land to each major unmarried daughters and major sons of all category of oustees with 1/1/87 as cut-off date for major sons and unmarried daughters.
4.	House plot	Free of cost allotment of house plot to each oustee family measuring 18.29 x 27.43 m (60' x 90') including major sons.	Residential developed plot of 502 Sq. m. (60' x 90') in rural areas will be given free to the oustee families and their Major sons.	<ol style="list-style-type: none"> <li>Residential plot of 500 sq.m. would be given free of charge to the oustee families and their major sons.</li> <li>Free core houses costing Rs.45,000/-</li> </ol>	<ol style="list-style-type: none"> <li>Residential plot of 500 sq.m. would be given free of charge to the oustee families and their major sons and unmarried major daughters.</li> <li>Free Mangalore tiles and bamboos.</li> </ol>

Sr. No.	Item	NWDT Award	Madhya Pradesh	Gujarat	Maharashtra
5.	Rehabilitation Grant, Grant-in-aid, Subsidy	Resettlement / rehabilitation grant @Rs.750/- per family inclusive of transportation charges. Grant-in-aid-upto Rs. 500/-	Scale of grant-in-aid for rehabilitation will be as follows : Rehabilitation Grant : All small & marginal farmers and all ST/SC farmers @ Rs. 11, 000 each: All other farmers @ Rs. 5500 each. All agricultural landless labourers & all SC/ST labourers, @ 11,000 each. All other labourers & land less families @ Rs. 5500 each. Major son of each oustee family will be treated as landless. He will be categorised amongst landless oustees as per his occupation.	Subsistence Allowance Each family will be paid subsistence allowance at Rs.15/- per day for 25 days in a month for a period of one year after resettlement. Rs.750/- per family with and increase of 8% per year worked out with January, 80 as base, as resettlement grant. Grant-in-aid upto Rs.500/- as per NWDT Award. Rs. 5000/- to purchase productive assets and Rs.10000/- to construct pucca house plinth. The above benefits at Sl.2 will be given to all category of oustees & their major sons.	Subsistence Allowance Each family will be paid subsistence allowance at Rs. 15/- per day for 25 days in a month for a period of one year after resettlement. Rs.750/- per family with an increase of 8% per year worked out with January, 80 as base, as resettlement grant. Grant-in-aid upto Rs.500/- as per NWDT Award. The above benefits at Sl. 2 will be provided to all category of oustees and their major sons and unmarried major daughters.

Sr. No.	Item	NWDT Award	Madhya Pradesh	Gujarat	Maharashtra
6.	Transportation Grant	Transportation charges to be met out of resettlement/rehabilitation grant Rs. 750/-	Free transport will be provided by the project. In case this facility is not availed of, a lumpsum relocation grant will be paid.	Free transport will be provided by State Government.	Free transport will be provided by State Government.
7.	Acquisition of Private land/ Houses which get isolated or physically cut-off	Not dealt with	Would be acquired and owners treated as oustees.	Would be acquired and owners treated as oustees.	Would be acquired and owners treated as oustees.
8.	Compensation (a) Land (b) Houses	As per Land Acquisition Act in operation at the time of acquisition.  As per Land Acquisition Act.	Compensation for land on the basis of price of similar land in adjacent command areas, Replacement value of House.	As per Land Acquisition Act as amended from time to time.  As per Land Acquisition Act.	As per Land Acquisition Act as amended from time to time.  As per Land Acquisition Act.
9.	Civic Amenities	1. One primary school (3 rooms for every 100 families) 2. One Panchayat Ghar for every 500 families. 3. One dispensary for every 500 families.	1. Drinking water well/ tube well with trough. 2. Link and approach road and drains. 3. Electricity. 4. Dispensary 5. Primary School	As per NWDT Award.	1. One primary School (3 rooms) for 100 families 2. One Panchayat Ghar for 500 families. 3. Samaj Mandir (cultural centre) for 500 families

70

Rehabilitation is Possible

Sr. No.	Item	NWDT Award	Madhya Pradesh	Gujarat	Maharashtra
		4. One seed store for every 500 families. 5. One children's park for every 500 families. 6. One village pond for every 500 families. 7. Drinking water well with trough for every 50 families. 8. One tree platform for every 50 families. 9. One religious place of worship for every 500 families. 10. Each colony should be linked to main road byroads of appropriate standards. 11. Electrification, water supply, sanitary arrangements etc.	6. P a n c h a y a t B h a w a n - c u m - Community Hall. 7. P l a y g r o u n d / Children's Park 8. Cattle shed 9. Place of Worship 10. Threshing ground 11. Seed Store 12. Tree Platform 13. Cremation & burial ground 14. Pond, wherever feasible 15. Social amenities for each municipal town viz. Water supply, sanitary arrangements etc. 16. Any other facility such as middle school which was existing in the		4. One health dispensary for 500 families 5. One seed store for 500 families. 6. One children's park for 500 families. 7. One village pond for 500 families. 8. Drinking water well with trough for 50 families. 9. Approach and internal roads. 10. One tree platform for every 50 families. 11. Play ground for school (1 Acre for Primary and 2 Acre for Secondary) 12. Electricity supply. 13. Open gutters. 14. Public Latrines. 15. Open place for collection of animals. 16. Khalwadi (Threshing platform)



Sr. No.	Item	NWDT Award	Madhya Pradesh	Gujarat	Maharashtra
			<p>affected village and its improvement.</p> <p>17. Ear marking of pasture land and its improvement.</p>		<p>17. S.T. Stand</p> <p>18. Grazing Land.</p> <p>19. Open place for Bazar.</p> <p>20. Cremation/burial ground.</p>
✓ 10.	Other facilities	Nil	<p>1. Where the option of interest free loan is not availed, the family would be assisted to the extent of a grant-in-aid of Rs. 1000/- per ha. Per year for 2 year.</p> <p>2. Age relaxation of 2 yrs. In Class III posts under the Govt. service.</p> <p>3. All welfare schemes being run at the site of displacement will be implemented at relocation sites also.</p>	<p>1. Special schemes for rehabilitating Dungri Bhils in their marriage circles.</p> <p>2. Priority in allotment of tankbed land.</p> <p>3. A non-agriculturist family i.e. Trader, Shopkeeper, Artisan, are given financial assistance upto Rs. 5000/- at the new site for resettling at the new location. He is also provided floor area equal to that lost at new site for carrying out trade. The</p>	<p>Relocation would be given priority in public employment subject to meeting minimum qualification and subject to age relaxation upto 3 years. Also attempt would be made to absorb as many oustees as possible in project works.</p> <p>1. Priority in Class - III &amp; IV posts. Reservation in project establishment.</p>

Sr. No.	Item	NWDT Award	Madhya Pradesh	Gujarat	Maharashtra
				<p>differential price is treated as ex-gratia.</p> <p>4. Preference in employment.</p> <p>5. All ongoing welfare schemes will be implemented at relocation sites also.</p>	<p>2. 50% reservation in Itl.</p> <p>3. 5% reserved for PAP's children in Class-III &amp; IV posts in all Govt. Semi Govt. Organisations and local authority.</p> <p>4. House building advance (i) Landholder- Rs. 8000/- (ii) Landless labours - Rs.4000/-</p> <p>5. Priority in allotment of tankbed land as per existing state policy.</p> <p>6. All ongoing welfare schemes will be implemented at relocation sites also.</p>

Resettlement

## APPENDIX – V

### SUBMERGENCE VILLAGE/S OF PAFs :

No.	Site	Submergence Village	No. of PAFs	Tribes				
				Tadavi	Rathva	Vasava	Bhil	Others
1	Shinor	1) Ferakada 2) Turkheda	23 23	--	33	13	--	-
2	Vadaj	1) Makadkhada	38	--	--	38	--	--
3	Golagamadi	1) Vadgam	100	96	--	--	--	04
4	Paniya	1) Hanfeshwar	55	--	03	--	52	--
5	Kolu	1) Vadgam 2) Navagam 3) Mokhadi 4) Katkhadi 5) Limadi	16 16 02 04 02	38	--	--	--	02
6	Kankuvasana	1) Mokhadi 2) Vadgam 3) Limadi	04 15 08	10	--	02	15	--
7	Ferkuva	1) Antaras 2) Hanfeshwar 3) Turkheda 4) Ferkada	25 08 06 07	--	--	--	46	--
8	Simalghoda	1) Ferkada	36	--	--	--	26	--
9	Agar	1) Gadher 2) Kokhadi	18 18	36	--	--	--	--
10	Sheera	1) Panchmuli 2) Mokhadi 3) Limadi	04 03 03	20	--	--	--	--
11	Khadgada	1) Khalvani 2) Navagam	-- --	57	--	--	--	--
12	Vaviyala	1) Navagam 2) Limadi	-- --	44	--	--	--	--
13	Dhanakiya	1) Turkheda	30	--	25	--	01	04

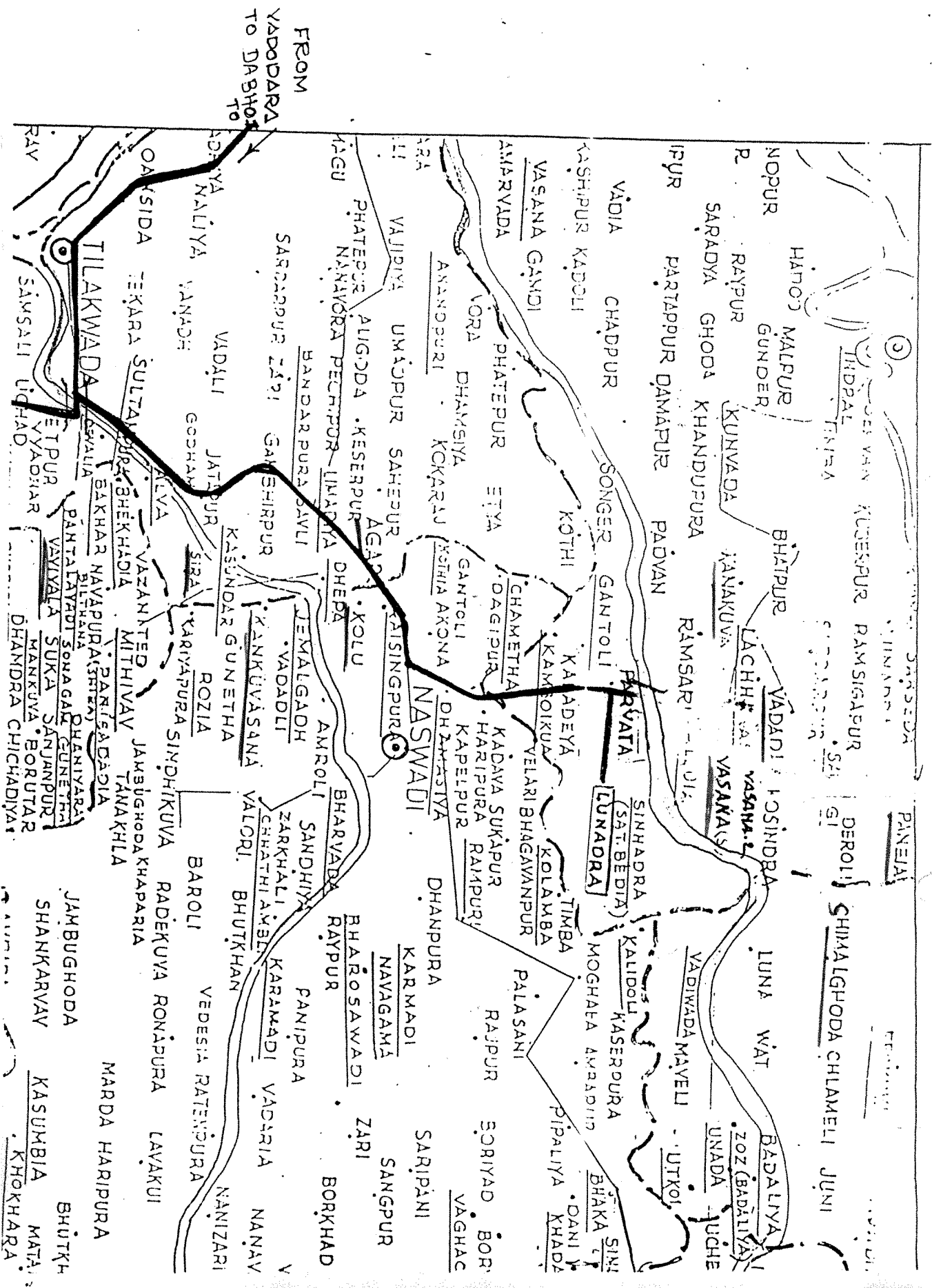

AREA TABLE		
S.NO.	PERICULAR	H.A. SQMT
1	RESIDENTIAL PLOT AREA	17640 "
2	AREA OF ROAD	6960 "
3	COMMON PLOT/O.S. AREA	12751 "
TOTAL AREA		37351 "

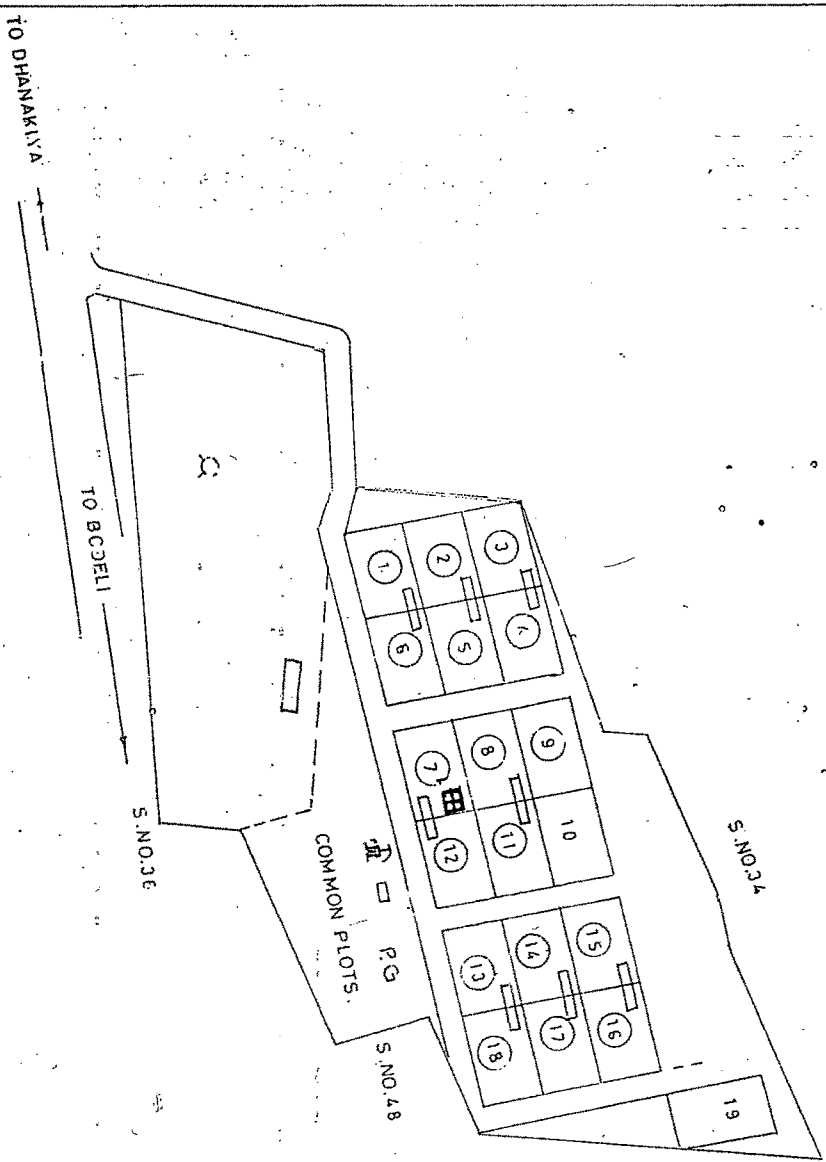
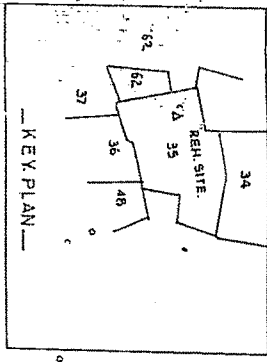
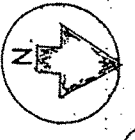

PLOTS ALLOTTED		PLOTS AVAILABLE		RESIDENTIAL PLOTS TO MAKE AVAILABLE FROM ADJOINING	
AGRI	RESI	AGRI	RESI		
17			2		

REFERENCES		
S.NO.	AGENCIES	NO. BY SYMBOL
1.	RESI. PLOTS ALLOT	33
2.	(A) OPEN WELL	31
	(B) 150mm DIA BORE WELL WITH HAND OPERATED WATER LIFTING DEVICES OR UNITS	1
	(C) PIPES LINES 150/200mm DIA BORE WELL POWER OPERATES/MANHOLES WITH LIFTING DEVICES WITH PIPE LINE 90/65 mm DIA TOTAL LENGTH WITH STAND POND	1 NO.
3.	PRIMARY SCHOOL	1
4.	SITTING PLATFORM	1
5.	APPROACH ROAD	0.30km
6.	INTERNAL ROAD	0.90 "
7.	CHILDREN PARK	1
8.	PLAY GROUND	1
9.	ONE HOUSE CONSTRUCTED...	1
10.	DISPENSARY	1

SARDAR SAROVAR PUNARVASATI AGENCY

LAY OUT PLAN FOR REHABILITATION SITE AT DHANKIYA, TA. JAMBUGHODA, DIST. PANCHMAHAL.

NARMADA PROJ. CONST (REH) DN 2 K. COLONY.

DY. EX. ENGR. EX. ENGR. SUPT. ENGR.

CHECKED BY. TRACED BY. S. K. B.

DRAWN BY. COMP. BY. S. K. B.

SCALE. DRNO. 154. DT. 12.10.96

S.NO	PARTICULAR	H. A. GAM
1	RESIDENTIAL PLOT AREA	11640 "
2	AREA OF ROAD	6300 "
3	COMMON PLOT O.S. AREA	12751 "
	TOTAL AREA	37291 "

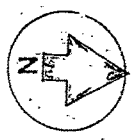

SHEET NO (20)

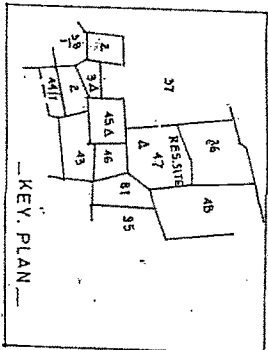

S. NO. 36

37

S. NO. 48

S. NO. 46

BODELI

DHANKIYA

17

1

2

3

4

5

6

7

8

9

10

11

12

13

14

15

16

17

18

19

20

21

22

PLOTS ALLOTED	PLOTS AVAILABLE	RESIDENTIAL PLOTS TO MAKE AVAILABLE FROM ADJOINING
AGRI/RESI	AGRI/RESI	LAND
9	7	

NO.	AGENTS	NO. OF SYMBOL
1.	RESIDENTIAL PLOTS READY FOR CONSTRUCTION	33
2.	(a) OPEN WELL	31
	(b) 150mm DIA BORE WELL WITH HAND OPERATED WATER LIFTING DEVICES OR DRIVEN APPROVED MOTORISED WATER LIFTING DEVICES WITH PATENT WITH THROUGH	1 NO
	(c) PIPE LINE 150/200mm DIA BORE WELL WITH OPERATED/MOTORISED WATER LIFTING DEVICES WITH PIPE LINE 90/65 mm DIA TOTAL LENGTH WITH STAND POSE	
3-9	PRIMARY SCHOOL	
4.	SITTING PLATFORM	
5.	APPROACH ROAD	
6.	INTERNAL ROAD	
7.	CHILDREN PARK	
8.	PLAY GROUND	
9.	CORE HOUSE CONSTRUCTION	
10.	DISPENSARY	

SARDAR SAROVAR PUNARVASVAT AGENCY.			
LAY OUT PLAN FOR REHABILITATION SITE, AT, DHANKIYA TAL. JAMBUGHODA. DIST. PANCHMAHAL.			
NARMADA PROJ CONST (REH) UNZK. COLONY.			
DY. EX. ENGR.	EX. ENGR.	SUPT. ENGR.	
DRAWN BY	TRACED BY	COMP BY	
CHECKED BY			
SCALE	DR. NO. 55	DT 13.10.96	

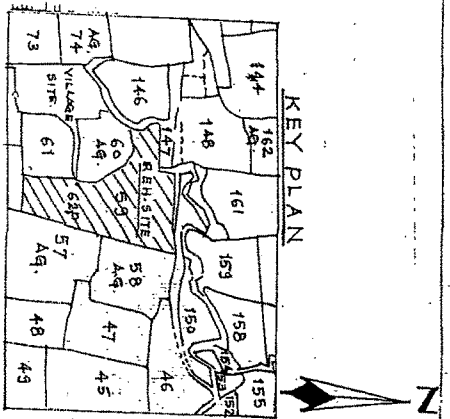
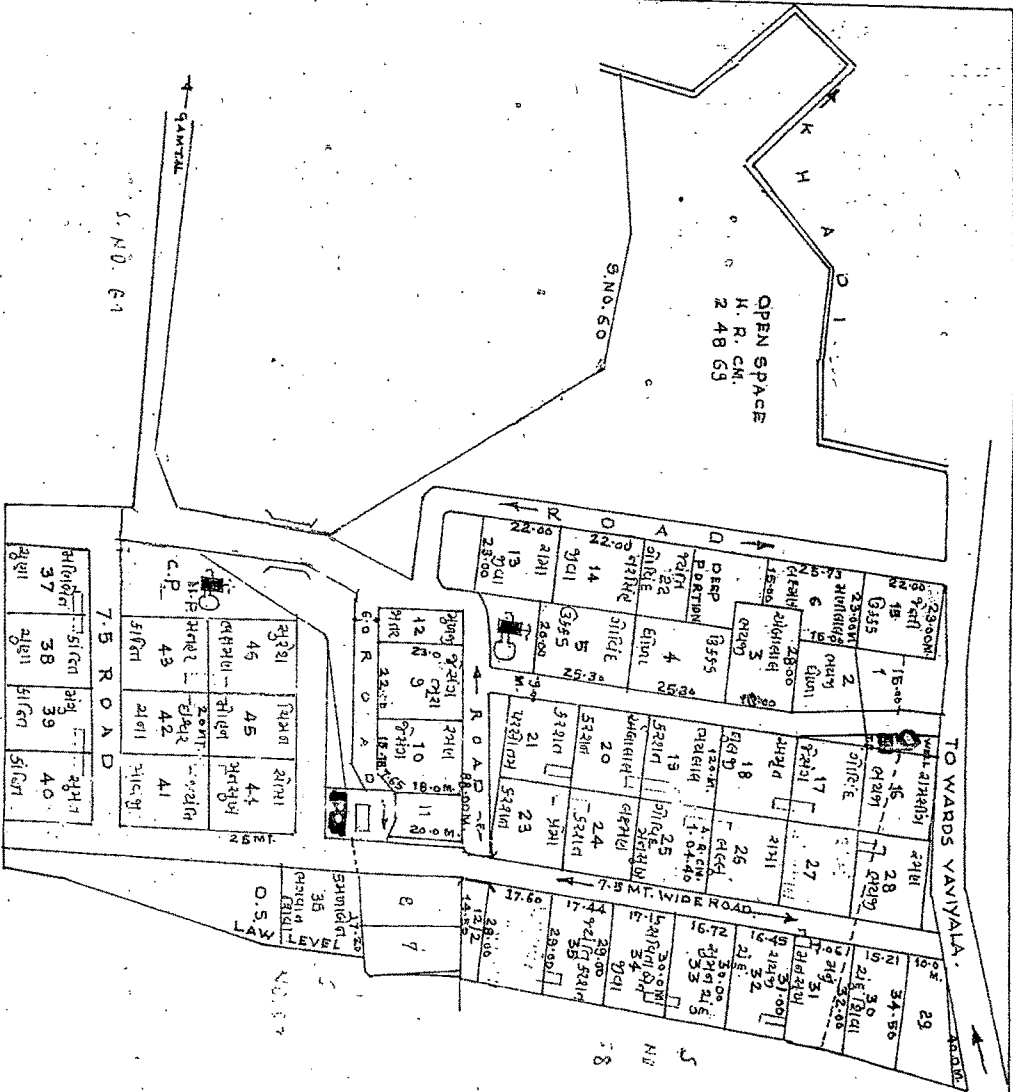

NO.	DESCRIPTION	SYMBOL
1.	RES. PLOTS	1-6
2.	OPEN WELL	7
3.	150mm DIA BORE WELL WITH HAND OPERATED WATER LIFTING DEVICES OR UNICEF PATTERNS WITH TROCK-II	8
4.	PIPE LINES 150/200mm DIA BORE WELL WITH OPERATING/MANHOLES WATER LIFTING DEVICES DIA 100mm LINE 90/65 mm WITH STAND POST	9
5.	PRIMARY SCHOOL	10
6.	SITTING PLATFORM	11
7.	APPROACH ROAD	12
8.	INTERNAL ROAD	13
9.	CHILDREN PARK	14
10.	PLAY GROUND	15
11.	CORE HOUSE	16
12.	DISBURSANT	17

SARDAR SAROVAR PUNARVASYAT AGENCY.  
LAY OUT PLAN FOR RES. SITE  
AT VAYALA TA. NANDOD.  
DIST. NARMADA.

NARMADA PROJ. CONST. (REND) D-1 K-1 COLONY.

BY EX. ENGR.	EX. ENGR.	SUPD. ENGR.
DRAWN BY	TRACED BY	COMP. BY
CHECKED BY	SCALE	1CM=10M.
DRG. NO. 928	DT. 22/12/97	

PLOTS ALLOTTED	PLOTS AVAILABLE	RESIDENTIAL PLOTS TO MAKE AVAILABLE FROM ADJOINING LAND
40	6	

Sr. No.	PARTICULAR	AREA
1.	RESIDENTIAL PLOT AREA	2.36-00
2.	AREA OF ROAD	0.53-00
3.	COMMON PLOT AREA	0.15-00
4.	UNUSEF LAND AREA	2.26-63
5.	TOTAL AREA.	3.24-63

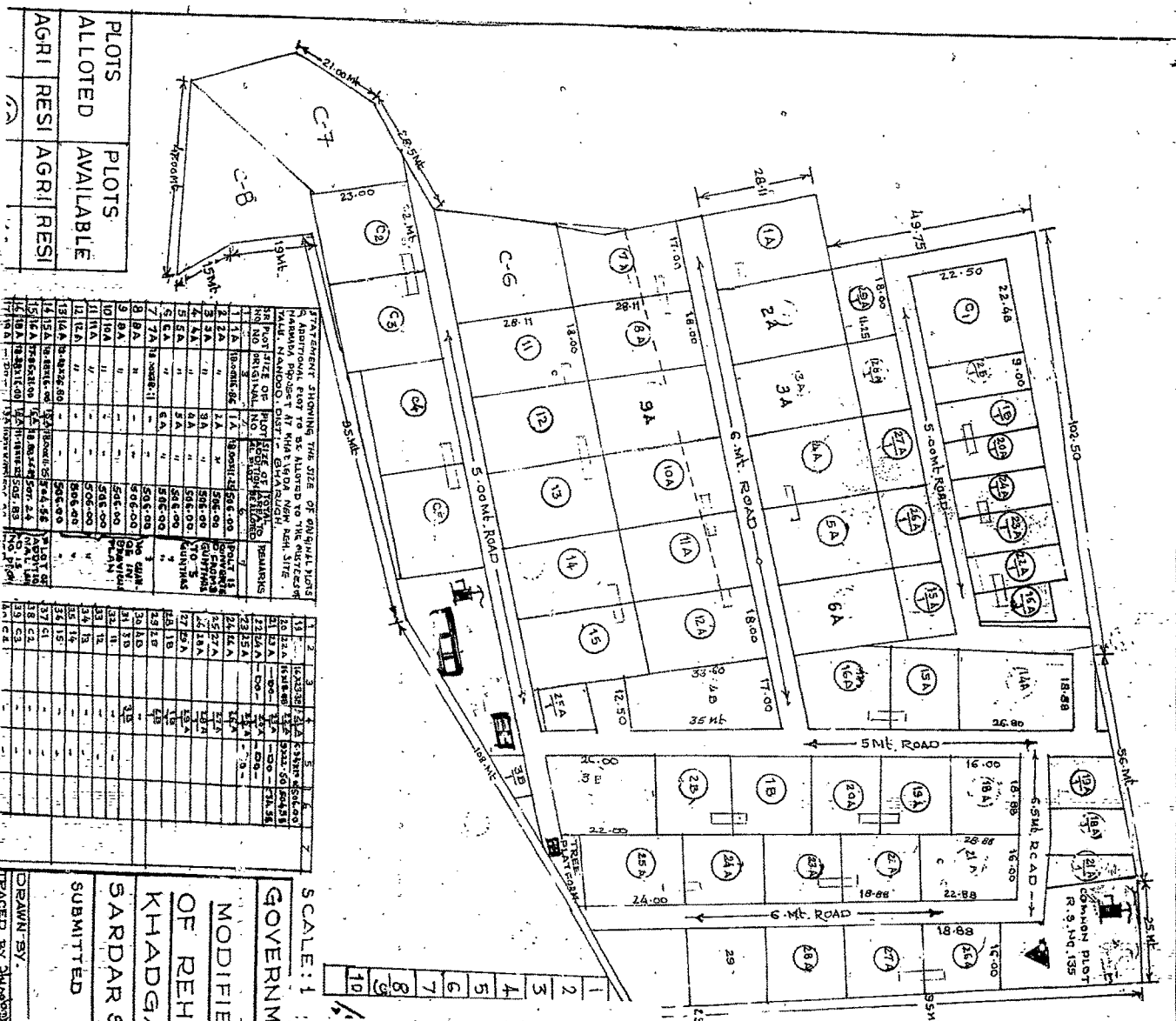

PLOTS ALLOTTED	PLOTS AVAILABLE
AGRI	RESI
RESI	AGRI
AGRI	RESI

STATEMENT SHOWING THE SIZE OF SUBDIVISIONS

NO.	NAME OF THE SUBDIVISION	AREA (SQ. M.)	AREA (SQ. YD.)	REMARKS
1	1A	18.00	21.48	
2	2A	18.00	21.48	
3	3A	18.00	21.48	
4	4A	18.00	21.48	
5	5A	18.00	21.48	
6	6A	18.00	21.48	
7	7A	18.00	21.48	
8	8A	18.00	21.48	
9	9A	18.00	21.48	
10	10A	18.00	21.48	
11	11A	18.00	21.48	
12	12A	18.00	21.48	
13	13A	18.00	21.48	
14	14A	18.00	21.48	
15	15A	18.00	21.48	
16	16A	18.00	21.48	
17	17A	18.00	21.48	
18	18A	18.00	21.48	
19	19A	18.00	21.48	
20	20A	18.00	21.48	
21	21A	18.00	21.48	
22	22A	18.00	21.48	
23	23A	18.00	21.48	
24	24A	18.00	21.48	
25	25A	18.00	21.48	

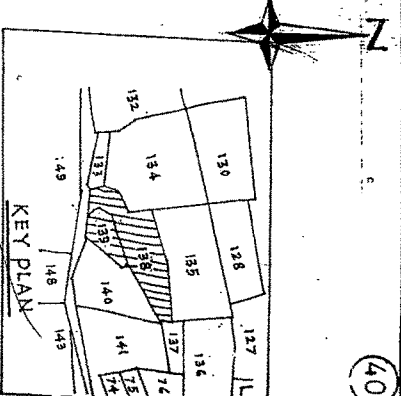

AREA TABLE

NO.	PARTICULAR	AREA (SQ. M.)	AREA (SQ. YD.)
1	RESIDENTIAL PLOT AREA	4.48	5.28
2	AREA OF ROAD	0.42	0.50
3	COMMON PLOT AREA	0.20	0.24
4	UNUSE LAND AREA	0.44	0.52
	TOTAL AREA	5.54	6.54

AGREEMENTS

NO.	AGREEMENT	NO. PROVIDED	SYMBOL
1	RESIDENTIAL PLOT AREA	1	
2	AREA OF ROAD	1	
3	COMMON PLOT AREA	1	
4	UNUSE LAND AREA	1	

SCALE: 1

GOVERNMENT OF GUJARAT

MODIFIED LAY OUT PLAN

OF REHABILITATION SITE OF

KHADGADA TA:- NANDOD

SARDAR SAROVAR (NARMADA) NIGAM LTD

SUBMITTED

RECOMMENDED

APPROVED

DRAWN BY: [Signature]

TRACED BY: [Signature]

KEVADIA INATE

NO. 11



LOTS ALLOTED	LOTS AVAILABLE	RESIDENTIAL PLOTS TO MAKE AVAILABLE FROM ADJOINING LAND
AGRI/RESI	AGRI/RESI	
14	70	

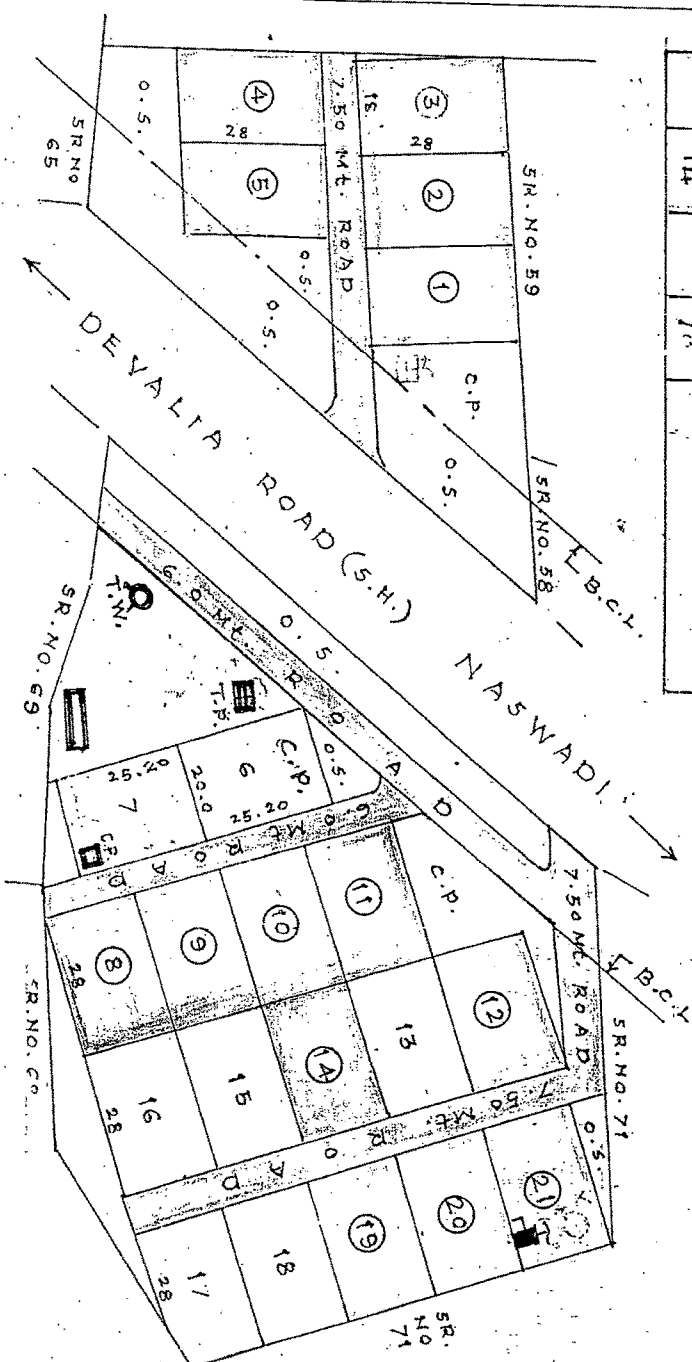

AREA TABLE		
Sr. No.	PARTICULAR	AREA H. A. SQM
1	RESIDENTIAL PLOT AREA	1-05-84
2	AREA OF ROAD	0-29-35
3	COMMON PLOT AREA	0-64-81
4	UNUSED LAND AREA	-
	TOTAL AREA	2-00-100

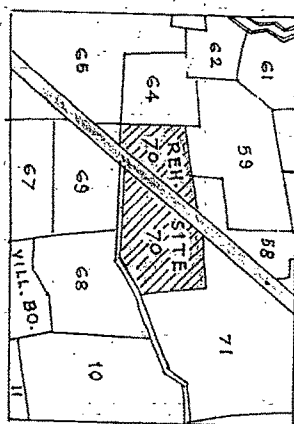

## KEY PLAN

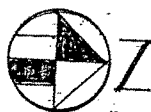

72

SR NO.	FUNCTIONS	NO. OF PERSONNEL
1.	RIGHT PLATE REGION / AVAILABLE CO-3301 ATTACHED	7 14
2.	(a) OCEAN VIEW ..... (b) 150mm DIA BORE WITH RATED OPERATING WATER LIFTING DEVICES OF UNITED STATES OF AMERICA PATTERN WITH TONGUE, ....	1 1
(c)	PIPE LINE- 150/200mm DIA BORE, WITH PROH OPERATING/MACHINICAL WATER LIFTING DEVICES WITH PIPE LINE 80/65 mm DIA TONGUE WITH CRANE VESSEL	1
3-6	PRIMARY SCHOOL, 1 ROOM SETTING PLANT/CRANE APPROACH ROAD ..... INTERNAL ROAD ..... CHILDREN PARK ..... PLAY GROUND ..... CORE HOUSE, 181/182/183/184/185/186/187/188/189/190/191/192/193/194/195/196/197/198/199/200/201/202/203/204/205/206/207/208/209/210/211/212/213/214/215/216/217/218/219/220/221/222/223/224/225/226/227/228/229/230/231/232/233/234/235/236/237/238/239/240/241/242/243/244/245/246/247/248/249/250/251/252/253/254/255/256/257/258/259/260/261/262/263/264/265/266/267/268/269/270/271/272/273/274/275/276/277/278/279/280/281/282/283/284/285/286/287/288/289/290/291/292/293/294/295/296/297/298/299/300/301/302/303/304/305/306/307/308/309/310/311/312/313/314/315/316/317/318/319/320/321/322/323/324/325/326/327/328/329/330/331/332/333/334/335/336/337/338/339/340/341/342/343/344/345/346/347/348/349/350/351/352/353/354/355/356/357/358/359/360/361/362/363/364/365/366/367/368/369/370/371/372/373/374/375/376/377/378/379/380/381/382/383/384/385/386/387/388/389/390/391/392/393/394/395/396/397/398/399/400/401/402/403/404/405/406/407/408/409/410/411/412/413/414/415/416/417/418/419/420/421/422/423/424/425/426/427/428/429/430/431/432/433/434/435/436/437/438/439/440/441/442/443/444/445/446/447/448/449/450/451/452/453/454/455/456/457/458/459/460/461/462/463/464/465/466/467/468/469/470/471/472/473/474/475/476/477/478/479/480/481/482/483/484/485/486/487/488/489/490/491/492/493/494/495/496/497/498/499/500/501/502/503/504/505/506/507/508/509/510/511/512/513/514/515/516/517/518/519/520/521/522/523/524/525/526/527/528/529/530/531/532/533/534/535/536/537/538/539/540/541/542/543/544/545/546/547/548/549/550/551/552/553/554/555/556/557/558/559/560/561/562/563/564/565/566/567/568/569/570/571/572/573/574/575/576/577/578/579/580/581/582/583/584/585/586/587/588/589/590/591/592/593/594/595/596/597/598/599/600/601/602/603/604/605/606/607/608/609/610/611/612/613/614/615/616/617/618/619/620/621/622/623/624/625/626/627/628/629/630/631/632/633/634/635/636/637/638/639/640/641/642/643/644/645/646/647/648/649/650/651/652/653/654/655/656/657/658/659/660/661/662/663/664/665/666/667/668/669/670/671/672/673/674/675/676/677/678/679/680/681/682/683/684/685/686/687/688/689/690/691/692/693/694/695/696/697/698/699/700/701/702/703/704/705/706/707/708/709/710/711/712/713/714/715/716/717/718/719/720/721/722/723/724/725/726/727/728/729/730/731/732/733/734/735/736/737/738/739/740/741/742/743/744/745/746/747/748/749/750/751/752/753/754/755/756/757/758/759/760/761/762/763/764/765/766/767/768/769/770/771/772/773/774/775/776/777/778/779/780/781/782/783/784/785/786/787/788/789/790/791/792/793/794/795/796/797/798/799/800/801/802/803/804/805/806/807/808/809/810/811/812/813/814/815/816/817/818/819/820/821/822/823/824/825/826/827/828/829/830/831/832/833/834/835/836/837/838/839/840/841/842/843/844/845/846/847/848/849/850/851/852/853/854/855/856/857/858/859/860/861/862/863/864/865/866/867/868/869/870/871/872/873/874/875/876/877/878/879/880/881/882/883/884/885/886/887/888/889/890/891/892/893/894/895/896/897/898/899/900/901/902/903/904/905/906/907/908/909/910/911/912/913/914/915/916/917/918/919/920/921/922/923/924/925/926/927/928/929/930/931/932/933/934/935/936/937/938/939/940/941/942/943/944/945/946/947/948/949/950/951/952/953/954/955/956/957/958/959/960/961/962/963/964/965/966/967/968/969/970/971/972/973/974/975/976/977/978/979/980/981/982/983/984/985/986/987/988/989/990/991/992/993/994/995/996/997/998/999/1000/1001/1002/1003/1004/1005/1006/1007/1008/1009/1010/1011/1012/1013/1014/1015/1016/1017/1018/1019/1020/1021/1022/1023/1024/1025/1026/1027/1028/1029/1030/1031/1032/1033/1034/1035/1036/1037/1038/1039/1040/1041/1042/1043/1044/1045/1046/1047/1048/1049/1050/1051/1052/1053/1054/1055/1056/1057/1058/1059/1060/1061/1062/1063/1064/1065/1066/1067/1068/1069/1070/1071/1072/1073/1074/1075/1076/1077/1078/1079/1080/1081/1082/1083/1084/1085/1086/1087/1088/1089/1090/1091/1092/1093/1094/1095/1096/1097/1098/1099/1100/1101/1102/1103/1104/1105/1106/1107/1108/1109/1110/1111/1112/1113/1114/1115/1116/1117/1118/1119/1120/1121/1122/1123/1124/1125/1126/1127/1128/1129/1130/1131/1132/1133/1134/1135/1136/1137/1138/1139/1140/1141/1142/1143/1144/1145/1146/1147/1148/1149/1150/1151/1152/1153/1154/1155/1156/1157/1158/1159/1160/1161/1162/1163/1164/1165/1166/1167/1168/1169/1170/1171/1172/1173/1174/1175/1176/1177/1178/1179/1180/1181/1182/1183/1184/1185/1186/1187/1188/1189/1190/1191/1192/1193/1194/1195/1196/1197/1198/1199/1200/1201/1202/1203/1204/1205/1206/1207/1208/1209/1210/1211/1212/1213/1214/1215/1216/1217/1218/1219/1220/1221/1222/1223/1224/1225/1226/1227/1228/1229/1230/1231/1232/1233/1234/1235/1236/1237/1238/1239/1240/1241/1242/1243/1244/1245/1246/1247/1248/1249/1250/1251/1252/1253/1254/1255/1256/1257/1258/1259/1260/1261/1262/1263/1264/1265/1266/1267/1268/1269/1270/1271/1272/1273/1274/1275/1276/1277/1278/1279/1280/1281/1282/1283/1284/1285/1286/1287/1288/1289/1290/1291/1292/1293/1294/1295/1296/1297/1298/1299/1300/1301/1302/1303/1304/1305/1306/1307/1308/1309/1310/1311/1312/1313/1314/1315/1316/1317/1318/1319/1320/1321/1322/1323/1324/1325/1326/1327/1328/1329/1330/1331/1332/1333/1334/1335/1336/1337/1338/1339/1340/1341/1342/1343/1344/1345/1346/1347/1348/1349/1350/1351/1352/1353/1354/1355/1356/1357/1358/1359/1360/1361/1362/1363/1364/1365/1366/1367/1368/1369/1370/1371/1372/1373/1374/1375/1376/1377/1378/1379/1380/1381/1382/1383/1384/1385/1386/1387/1388/1389/1390/1391/1392/1393/1394/1395/1396/1397/1398/1399/1400/1401/1402/1403/1404/1405/1406/1407/1408/1409/1410/1411/1412/1413/1414/1415/1416/1417/1418/1419/1420/1421/1422/1423/1424/1425/1426/1427/1428/1429/1430/1431/1432/1433/1434/1435/1436/1437/1438/1439/1440/1441/1442/1443/1444/1445/1446/1447/1448/1449/1450/1451/1452/1453/1454/1455/1456/1457/1458/1459/1460/1461/1462/1463/1464/1465/1466/1467/1468/1469/1470/1471/1472/1473/1474/1475/1476/1477/1478/1479/1480/1481/1482/1483/1484/1485/1486/1487/1488/1489/1490/1491/1492/1493/1494/1495/1496/1497/1498/1499/1500/1501/1502/1503/1504/1505/1506/1507/1508/1509/1510/1511/1512/1513/1514/1515/1516/1517/1518/1519/1520/1521/1522/1523/1524/1525/1526/1527/1528/1529/1530/1531/1532/1533/1534/1535/1536/1537/1538/1539/1540/1541/1542/1543/1544/1545/1546/1547/1548/1549/1550/1551/1552/1553/1554/1555/1556/1557/1558/1559/1560/1561/1562/1563/1564/1565/1566/1567/1568/1569/1570/1571/1572/1573/1574/1575/1576/1577/1578/1579/1580/1581/1582/1583/1584/1585/1586/1587/1588/1589/1590/1591/1592/1593/1594/1595/1596/1597/1598/1599/1600/1601/1602/1603/1604/1605/1606/1607/1608/1609/1610/1611/1612/1613/1614/1615/1616/1617/1618/1619/1620/1621/1622/1623/1624/1625/1626/1627/1628/1629/1630/1631/1632/1633/1634/1635/1636/1637/1638/1639/1640/1641/1642/1643/1644/1645/1646/1647/1648/1649/1650/1651/1652/1653/1654/1655/1656/1657/1658/1659/1660/1661/1662/1663/1664/1665/1666/1667/1668/1669/1670/1671/1672/1673/1674/1675/1676/1677/1678/1679/1680/1681/1682/1683/1684/1685/1686/1687/1688/1689/1690/1691/1692/1693/1694/1695/1696/1697/1698/1699/1700/1701/1702/1703/1704/1705/1706/1707/1708/1709/1710/1711/1712/1713/1714/1715/1716/1717/1718/1719/1720/1721/1722/1723/1724/1725/1726/1727/1728/1729/1730/1731/1732/1733/1734/1735/1736/1737/1738/1739/1740/1741/1742/1743/1744/1745/1746/1747/1748/1749/1750/1751/1752/1753/1754/1755/1756/1757/1758/1759/1760/1761/1762/1763/1764/1765/1766/1767/1768/1769/1770/1771/1772/1773/1774/1775/1776/1777/1778/1779/1780/1781/1782/1783/1784/1785/1786/1787/1788/1789/1790/1791/1792/1793/1794/1795/1796/1797/1798/1799/1800/1801/1802/1803/1804/1805/1806/1807/1808/1809/1810/1811/1812/1813/1814/1815/1816/1817/1818/1819/1820/1821/1822/1823/1824/1825/1826/1827/1828/1829/1830/1831/1832/1833/1834/1835/1836/1837/1838/1839/1840/1841/1842/1843/1844/1845/1846/1847/1848/1849/1850/1851/1852/1853/1854/1855/1856/1857/1858/1859/1860/1861/1862/1863/1864/1865/1866/1867/1868/1869/1870/1871/1872/1873/1874/1875/1876/1877/1878/1879/1880/1881/1882/1883/1884/1885/1886/1887/1888/1889/1890/1891/1892/1893/1894/1895/1896/1897/1898/1899/1900/1901/1902/1903/1904/1905/1906/1907/1908/1909/1910/1911/1912/1913/1914/1915/1916/1917/1918/1919/1920/1921/1922/1923/1924/1925/1926/1927/1928/1929/1930/1931/1932/1933/1934/1935/1936/1937/1938/1939/1940/1941/1942/1943/1944/1945/1946/1947/1948/1949/1950/1951/1952/1953/1954/1955/1956/1957/1958/1959/1960/1961/1962/1963/1964/1965/1966/1967/1968/1969/1970/1971/1972/1973/1974/1975/1976/1977/1978/1979/1980/1981/1982/1983/1984/1985/1986/1987/1988/1989/1990/1991/1992/1993/1994/1995/1996/1997/1998/1999/2000/2001/2002/2003/2004/2005/2006/2007/2008/2009/2010/2011/2012/2013/2014/2015/2016/2017/2018/2019/2020/2021/2022/2023/2024/2025/2026/2027/2028/2029/2030/2031/2032/2033/2034/2035/2036/2037/2038/2039/2040/2041/2042/2043/2044/2045/2046/2047/2048/2049/2050/2051/2052/2053/2054/2055/2056/2057/2058/2059/2060/2061/2062/2063/2064/2065/2066/2067/2068/2069/2070/2071/2072/2073/2074/2075/2076/2077/2078/2079/2080/2081/2082/2083/2084/2085/2086/2087/2088/2089/2090/2091/2092/2093/2094/2095/2096/2097/2098/2099/2100/2101/2102/2103/2104/2105/2106/2107/2108/2109/2110/2111/2112/2113/2114/2115/2116/2117/2118/2119/2120/2121/2122/2123/2124/2125/2126/2127/2128/2129/2130/2131/2132/2133/2134/2135/2136/2137/2138/2139/2140/2141/2142/2143/2144/2145/2146/2147/2148/2149/2150/2151/2152/2153/2154/2155/2156/2157/2158/2159/2160/2161/2162/2163/2164/2165/2166/2167/2168/2169/2170/2171/2172/2173/2174/2175/2176/2177/2178/2179/2180/2181/2182/2183/2184/2185/2186/2187/2188/2189/2190/2191/2192/2193/2194/2195/2196/2197/2198/2199/2200/2201/2202/2203/2204/2205/2206/2207/2208/2209/2210/2211/2212/2213/2214/2215/2216/2217/2218/2219/2220/2221/2222/2223/2224/2225/2226/2227/2228/2229/2230/2231/2232/2233/2234/2235/2236/2237/2238/2239/2240/2241/2242/2243/2244/2245/2246/2247/2248/2249/2250/2251/2252/2253/2254/2255/2256/2257/2258/2259/2260/2261/2262/2263/2264/2265/2266/2267/2268/2269/2270/2271/2272/2273/2274/2275/2276/2277/2278/2279/2280/2281/2282/2283/2284/2285/2286/2287/2288/2289/2290/2291/2292/2293/2294/2295/2296/2297/2298/2299/2300/2301/2302/2303/2304/2305/2306/2307/2308/2309/2310/2311/2312/2313/2314/2315/2316/2317/2318/2319/2320/2321/2322/2323/2324/2325/2326/2327/2328/2329/2330/2331/2332/2333/2334/2335/2336/2337/2338/2339/2340/2341/2342/2343/2344/2345/2346/2347/2348/2349/2350/2351/2352/2353/2354/2355/2356/2357/2358/2359/2360/2361/2362/2363/2364/2365/2366/2367/2368/2369/2370/2371/2372/2373/2374/2375/2376/2377/2378/2379/2380/2381/2382/2383/2384/2385/2386/2387/2388/2389/2390/2391/2392/2393/2394/2395/2396/2397/2398/2399/2400/2401/2402/2403/2404/2405/2406/2407/2408/2409/2410/2411/2412/2413/2414/2415/2416/2417/2418/2419/2420/2421/2422/2423/2424/2425/2426/2427/2428/2429/2430/2431/2432/2433/2434/2435/2436/2437/2438/2439/2440/2441/2442/2443/2444/2445/2446/2447/2448/2449/2450/2451/2452/2453/2454/2455/2456/2457/2458/2459/2460/2461/2462/2463/2464/2465/2466/2467/2468/2469/2470/2471/2472/2473/2474/2475/2476/2477/2478/2479/2480/2481/2482/2483/2484/2485/2486/2487/2488/2489/2490/2491/2492/2493/2494/2495/2496/2497/2498/2499/2500/2501/2502/2503/2504/2505/2506/2507/2508/2509/2510/2511/2512/2513/2514/2515/2516/2517/2518/2519/2520/2521/2522/2523/2524/2525/2526/2527/2528/2529/2530/2531/2532/2533/2534/2535/2536/2537/2538/2539/2540/2541/2542/2543/2544/2545/2546/2547/2548/2549/2550/2551/2552/2553/2554/2555/2556/2557/2558/2559/2560/2561/2562/2563/2564/2565/2566/2567/2568/2569/2570/2571/2572/2573/2574/2575/2576/2577/2578/2579/2580/2581/2582/2583/2584/2585/2586/2587/2588/2589/2590/2591/2592/2593/2594/2595/2596/2597/2598/2599/2600/2601/2602/2603/2604/2605/2606/2607/2608/2609/2610/2611/2612/2613/2614/2615/2616/2617/2618/2619/2620/2621/2622/2623/2624/2625/2626/2627/2628/2629/2630/2631/2632/2633/2634/2635/2636/2637/2638/2639/2640/2641/2642/2643/2644/2645/2646/2647/2648/2649/2650/2651/2652/2653/2654/2655/2656/2657/2658/2659/2660/2661/2662/2663/2664/2665/2666/2667/2668/2669/2670/2671/2672/2673/2674/2675/2676/2677/2678/2679/2680/2681/2682/2683/2684/2685/2686/2687/2688/2689/2690/2691/2692/2693/2694/2695/2696/2697/2698/2699/2700/2701/2702/2703/2704/2705/2706/2707/2708/2709/2710/2711/2712/2713/2714/2715/2716/2717/2718/2719/2720/2721/2722/2723/2724/2725/2726/2727/2728/2729/2730/2731/2732/2733/2734/2735/2736/2737/2738/2739/2740/2741/2742/2743/2744/2745/2746/2747/2748/2749/2750/2751/2752/2753/2754/2755/2756/2757/2758/2759/2760/2761/2	

SARDAR SARGYAR PUNAEVASYAT AGENCY

LAY OUT PLAN FOR REH SITE  
AT, SHIRATA, TILAKWADA  
DIST. NARMADA.

NARAYANA PROJ. CONST. (REH) DM-1 K' colony

BY EX. ENGR.	EX. ENGR.	SUPTD. ENGR
--------------	-----------	-------------

DRAWN BY: TRACED BY: *W. J. J. J.*

CHECKED BY. comp by. Rllowet.

SCALE	1cm = 10 Mt.
DRAW NO.	1056-T-8/11/2000

SHEET.NO. C

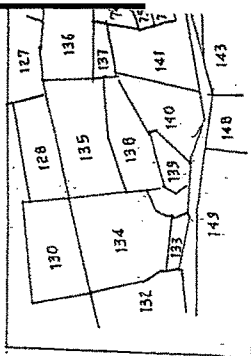

KEY PLAN

REFERENCES

NO.	AGRICULTURE	NO. PROVIDED	SCHOOL
1.	REST PLOTS READY AVAILABLE	10	
2.	(A) OPEN WELL	12	
	(B) 150mm DIA BORE WELL WITH HAND OPERATED WATER LIFTING DEVICES		
	(C) PILE LINER 150/300mm DIA BORE WELL POWER OPERATED/MANUAL WATER LIFTING DEVICES		
3-6	PRIMARY SCHOOL		
4.	SITTING PLATFORM		
5.	APPROACH ROAD		
6.	INTERNAL ROAD		
7.	CHILDREN PARK		
8.	PLAY GROUND		
9.	CORE HOUSE		
10.	DISPENSARY		

AREA TABLE

1	TOTAL LAND AREA	16186 M.
2	NOS OF PLOTS	22 NOS.
3	PLOTS AREA	11088 M.
4	COMMON PLOTS AREA	1510.50 M
5	OPEN SPACE	991.0 M
6	INT. ROAD AREA	2587.50 M.
7	APPROACH ROAD (LENGTH)	
8	INT. ROAD LENGTH	0.345 KM.

RESIDENTIAL PLOTS TO MAKE AVAILABLE FROM ADJOINING LAND.

PLOTS ALLOTTED	PLOTS AVAILABLE	RESIDENTIAL PLOTS TO MAKE AVAILABLE FROM ADJOINING LAND.
AGRI RES	RESI	
12	10	

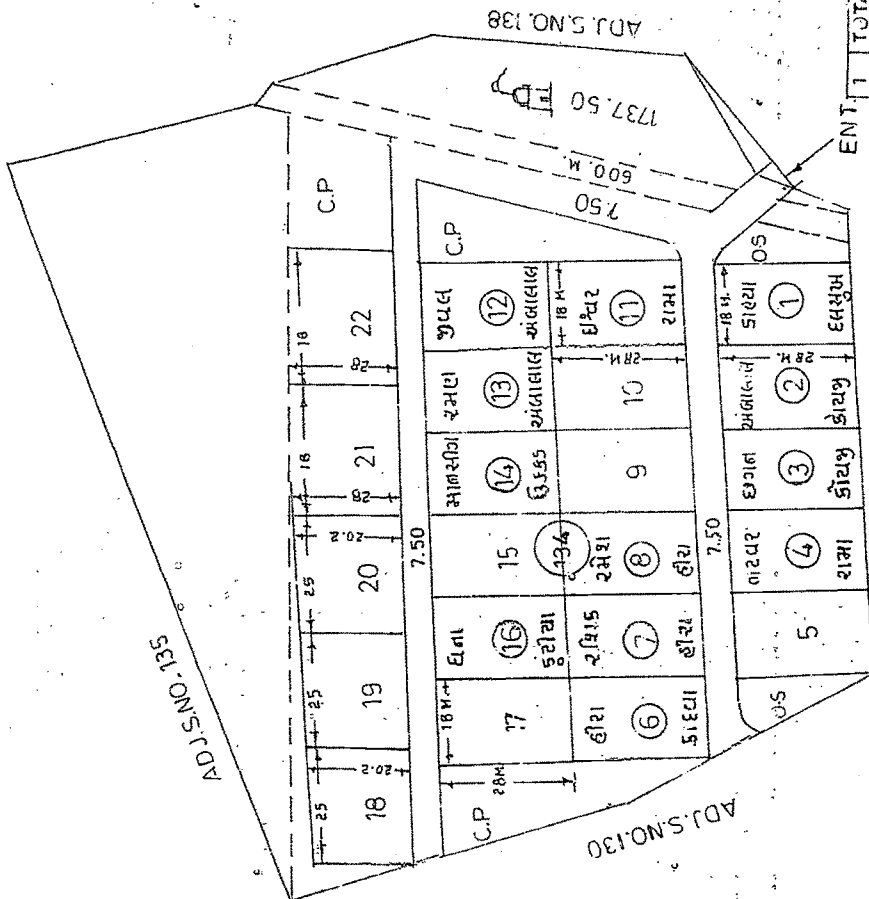

ADJ. S.NO 132

LAYOUT PLAN

SARDAR SAROVAR PUNARVASVAT AGENCY.

LAY OUT PLAN OF REH.SITE

AT: KHADGADA (EXT)

TA: NANOD, DIST: NARMADA.

NARMADA PROJ.CONST(REDHON-2,K)COLONY

DY. EX. ENGR

EX. ENGR

SUPP. ENGR

DRAWN BY: TRACE D.BY: (D.H.TURID)

CHECK'D BY: COMP'D BY:

SCALE

DRG. NO.

DT: 6.7.2004



## KEY PLAN

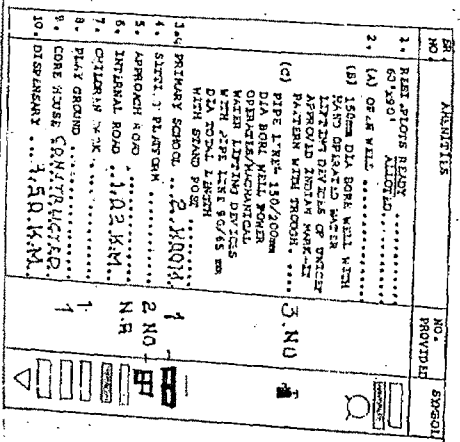

CYLX ENGR.		EX. ENGINEER		SUPTD. ENGR.	
DRAWN BY:		TRACED BY:		CHECKED BY:	
CHECKED BY:		COMP. BY:			

NOTE:  
LAY OUT SANCTIONED BY ASSTT.  
TOWN PLANNER NARMADA PLANNING  
UNIT VADODARA LETTER NO.  
R RTP / 157 / 11 / 2000 DT. 10 / 3 / 2000.

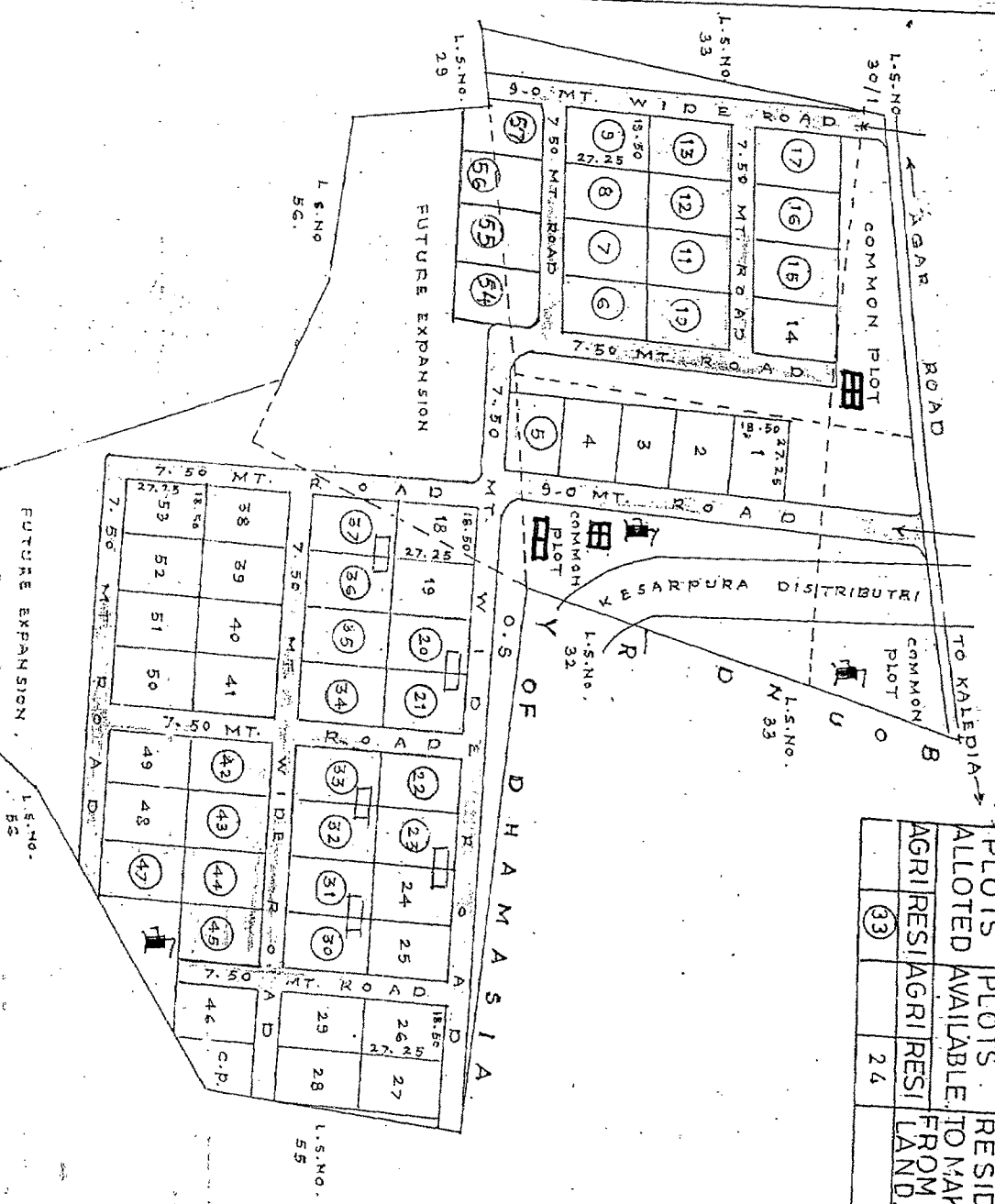

PLOTS ALLOTED	PLOTS AVAILABLE	RESIDENTIAL PLOTS TO MAKE AVAILABLE FROM ADJOINING LAND
AGRI RESI 2	AGRI RESI 21	

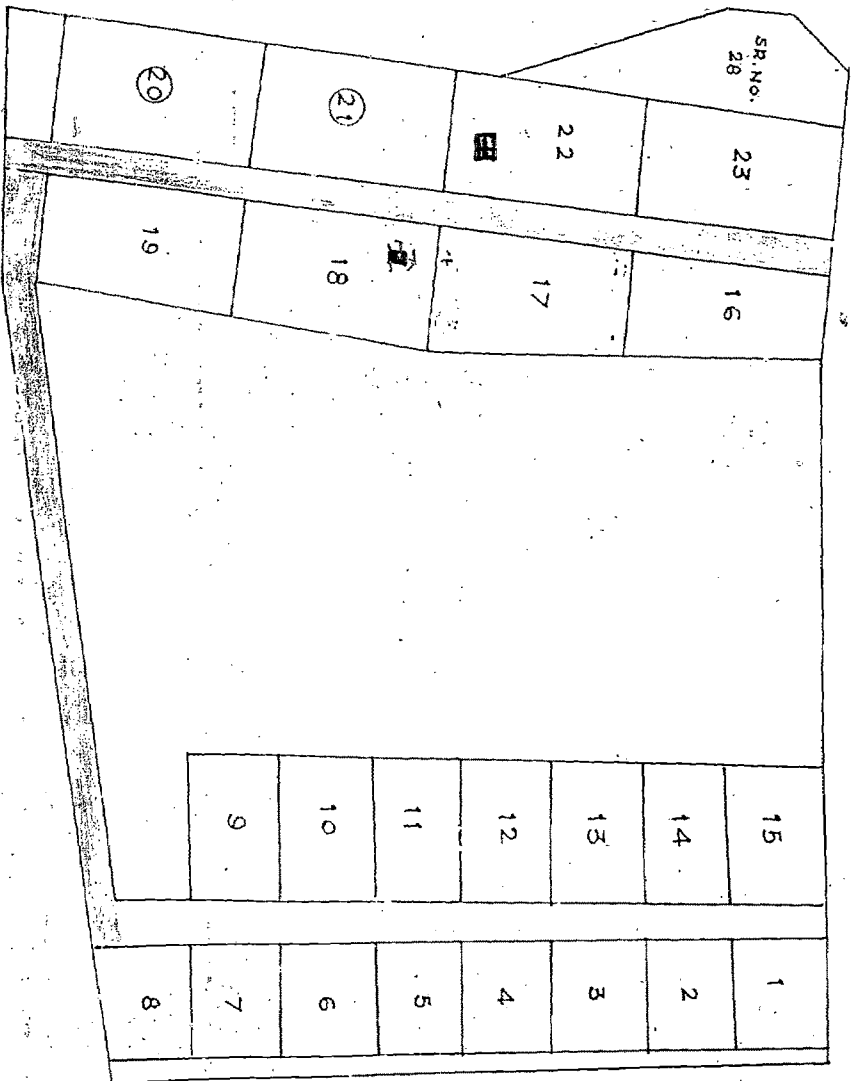

SR. NO.	PARTICULAR	AREA
1	RESIDENTIAL PLOT AREA	1-15-53
2	AREA OF ROAD	3-19-13
3	COMMON PLOT AREA	1-13-34
4	UNUSE LAND AREA	-
	TOTAL AREA	2-48-00

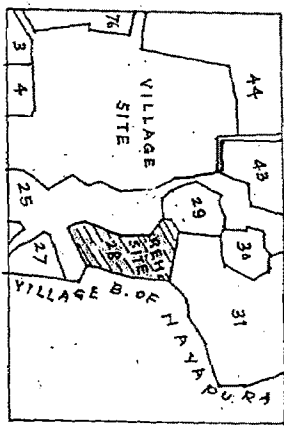

KEY PLAN

SR. NO.	AMENITIES	NO. PROVIDED	SYMBOL
1.	REST PLOTS READY AVAILABLE	21	
2.	(A) OPEN WELL	2	
	(B) 150mm DIA BORE WELL WITH HAND OPERATED WATER LIFTING DEVICES OR UNDER APPROVED INDIAN MARK-II PATENT WITH TROUGH	1	
	(C) PIPE LINE- 150/200mm DIA TUBE WELL POWER OPERATED/MECHANICAL WITH 150mm DIA BORE WITH PIPE LINE 80/65 mm DIA COIL 1 WITH WITH STAND POST	1	
3.	PRIMARY SCHOOL		
4.	SITTING PLATFORM		
5.	APPROACH ROAD		
6.	INTERNAL ROAD		
7.	CHILDREN PARK		
8.	PLAY GROUND		
9.	CORE HOUSE		
10.	DISPENSARY		

SARDAR SAROVAR DUNAVASAT AGENCY

LAY OUT PLAN FOR RES. SITE AT SHIKHA TAL: TILAKWADA DIST: VADODARA

NARAYANA PROJ. CONST. (RED) DPT. COLONY

DESIGNED BY: EX-ENGR. TRACED BY: SPT-ENGR.

CHECKED BY: DPT. COMPLY BY: K.M.V.

SCALE: ORG. NO. 937 DT. 16/11/98

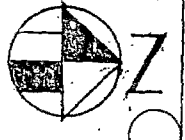

PLOTS ALLOTTED		PLOTS AVAILABLE		RESIDENTIAL PLOTS TO MAKE AVAILABLE FROM ADJOINING LAND
AGRI	RESI	AGRI	RESI	
	(16)		15	

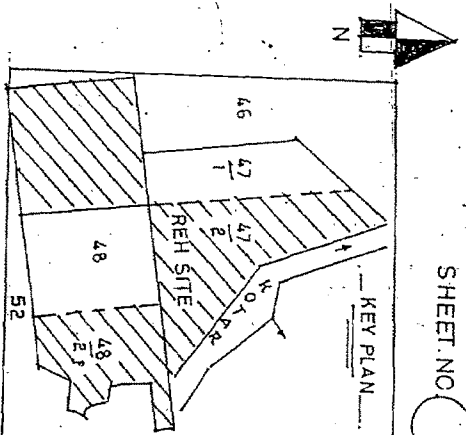

RESI. PLOTS AVAILABLE	15 NO	<input type="checkbox"/>
RESI PLOTS ALLOTTED	16 NO	<input type="checkbox"/>
HAND PUMP	1 NO	<input checked="" type="checkbox"/>
PRIMARY SCHOOL	2 ROOM	<input checked="" type="checkbox"/>
APPROACH ROAD		<input type="checkbox"/>
INTERNAL ROAD		<input checked="" type="checkbox"/>
TREE PLAT FORM	1 NO	<input checked="" type="checkbox"/>
CHILDREN PARK	1 NO	<input checked="" type="checkbox"/>
CORE HOUSE		<input checked="" type="checkbox"/>
OPEN WELL		<input checked="" type="checkbox"/>
DENSARY		<input checked="" type="checkbox"/>
HAWADA		<input checked="" type="checkbox"/>

SARDAR SAFOVAR PUNARASAT AGENCY.

LAY OUT PLAN FOR REHABILITATION SITE  
AT: KHARADA, TA:PAVJETPUR

DIST. VADODARA

NARMADA PROD. CONT(RED)DN2.K: COLONY.

5. NO.	PARTICULAR	SG. MT.	DY. EX ENGR	EX. ENGR	SUPTDG. ENGR
1	RESIDENTIAL PLOT AREA.	9000	DRAWN. BY:	TRACED. BY. D. H. TURI.	
2	AREA OF ROAD.		CHECKED. BY:	COMP. BY:	
3	COMMON PLOT AREA	5906			
4	UNUSE LAND AREA				
5	TOTAL AREA.	14906	SCALE: 1 CM = 10 M	DRG. NO.	DT: 10.12.08

• AREA TABLE •

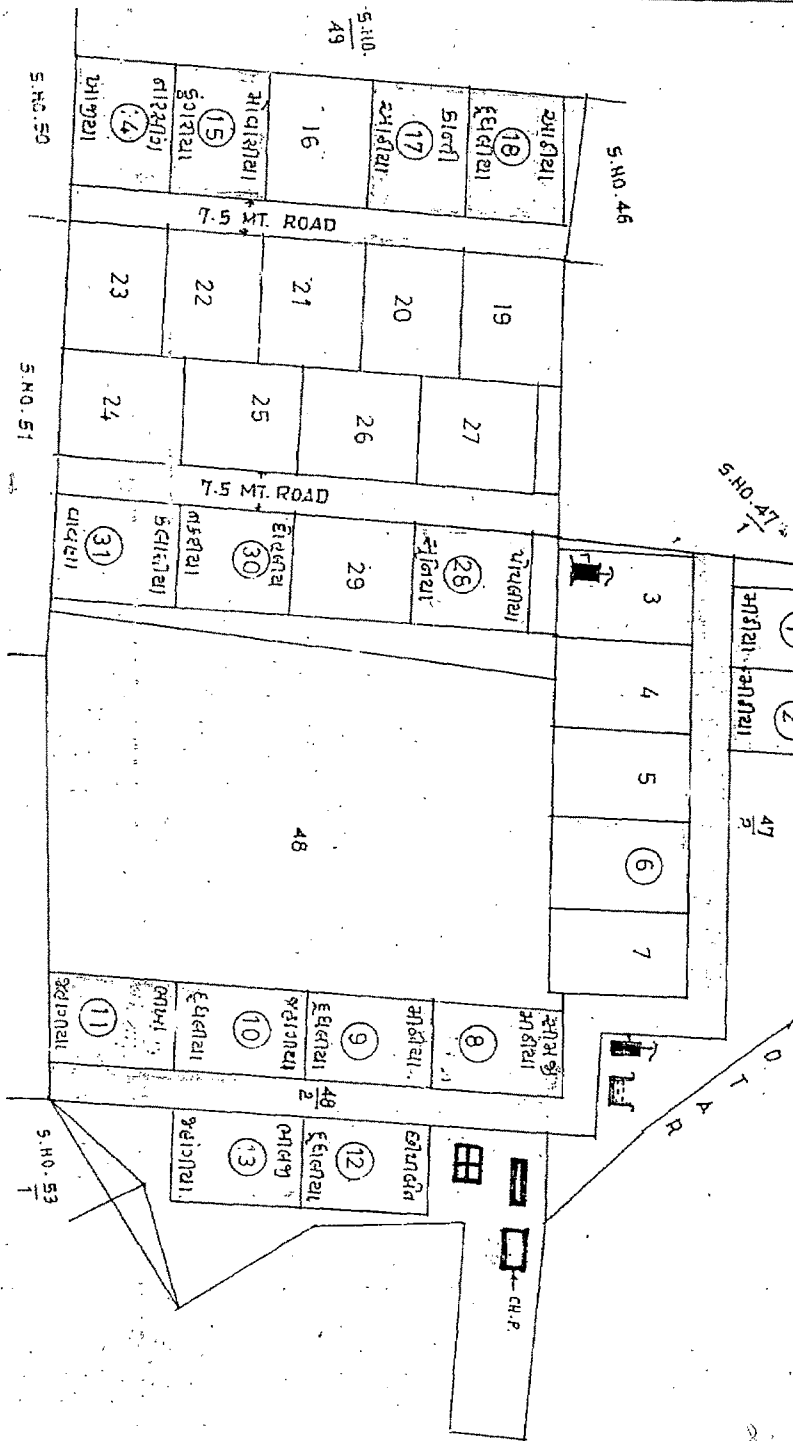

AREA TABLE		
S.NO	PARTICULAR	H.A. SQM
1.	RESIDENTIAL PLOT AREA	23000
2.	AREA OF ROAD	12439
3.	COMMON PLOT/O.S. AREA	
TOTAL AREA		35439

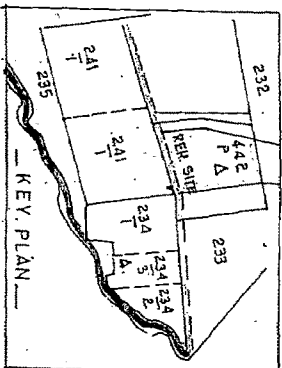
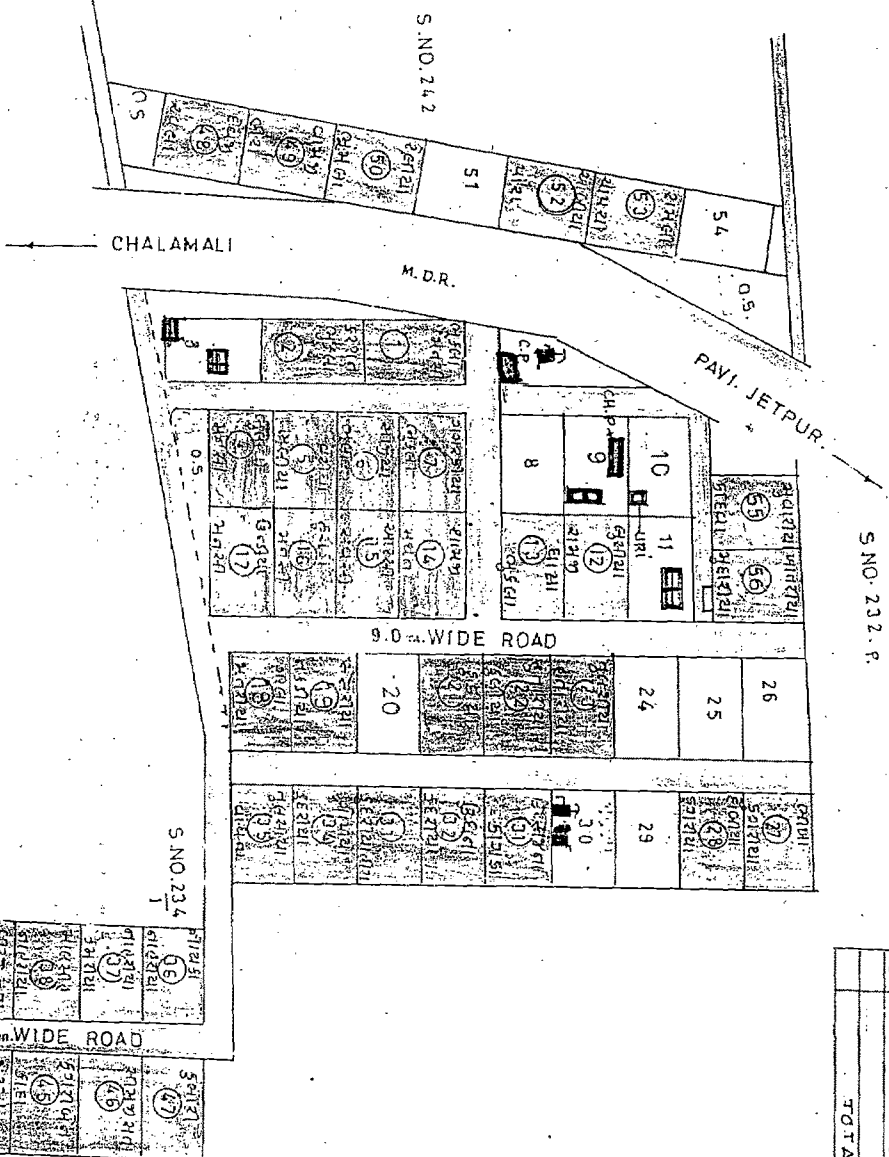
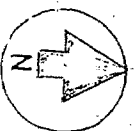

KEY PLAN

NO.	AMENITIES	NO. PROVIDED	SYMBOL
1.	REST ROOMS	1	1
2.	(A) OPEN WELL	1	2
	(B) 150mm DIA BORE WELL WITH HAND OPERATED WATER LIFTING DEVICES OR UNDER APPROVED INDIAN STANDARDS PATTERNS WITH INDOOR	2	3
	(C) PIPE LINE - 150/200mm DIA BORE WELL WITH WATER LIFTING DEVICES WITH PIPE LINE 80/65 mm DIA TOTAL LENGTH WITH STAND POST	2	4
3-4	PRIMARY SCHOOL	1	5
4.	SITTING PLATFORM	2	6
5.	PERGOCH ROAD	2	7
6.	IMPERIAL ROAD	1	8
7.	CHILDREN PARK	1	9
8.	PLAY GROUND	1	10
9.	COKE HOUSE	1	11
10.	DISPENSARY	1	12

SARDAR SAROVAR PUNARVSAI AGENCY

LAY OUT PLAN FOR REHABILITATION

SITE AT FERKUYA 2 TA. PAVI. JETPUR  
DIST. VADODARA

NARMADA PROJ. CONT. (REH) DN. 2 K. COLONY

PLOTS ALLOTTED	PLOTS AVAILABLE	RESIDENTIAL PLOTS TO MAKE AVAILABLE FROM ADJOINING LAND
AGRI. RESI	AGRI. RESI	
(39)		

DY. EX. ENGR.	EX. ENGR.	SUPT. ENGR.
CHECKED BY	TRACED BY	ADJ. BY
DRAWN BY	COMP. BY	ADJ. BY
SCALE	DR. NO. 157	DT. 14.09.96

# KEY PLAN

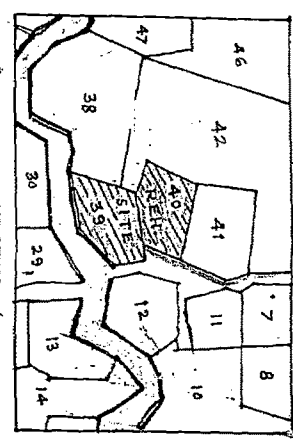

NO.	AMOUNTS	NO.	SYMBOL
1.	RES. PLOTS REGR. 60'x90' ALLOTTED	4	25
2.	(A) OPEN WILL	1	-
	(B) 150m x 150m WELL WITH APPROVED INDIA MARK-II PATTERN WITH THROUGH	2	NO
	(C) PIPE LINE-150/100mm I.I.A BORE WELL POWER OPERATING/MANUAL WITH LIFTING DEVICES WITH 150m x 150m x 150m DISCHARGE LAMP WITH STAND POLE	1	25
3.	PRIMARY SCHOOL 1 ROOM	1	-
4.	SITTING PLATFORM	1	-
5.	APPROACH ROAD	1.7	km
6.	INTERIOR ROAD	0.5	km
7.	CHILDREN PARK	1	-
8.	PLAY GROUND	1	-
9.	WELL HOUSE	1	-
10.	DISPENSARY	1	-

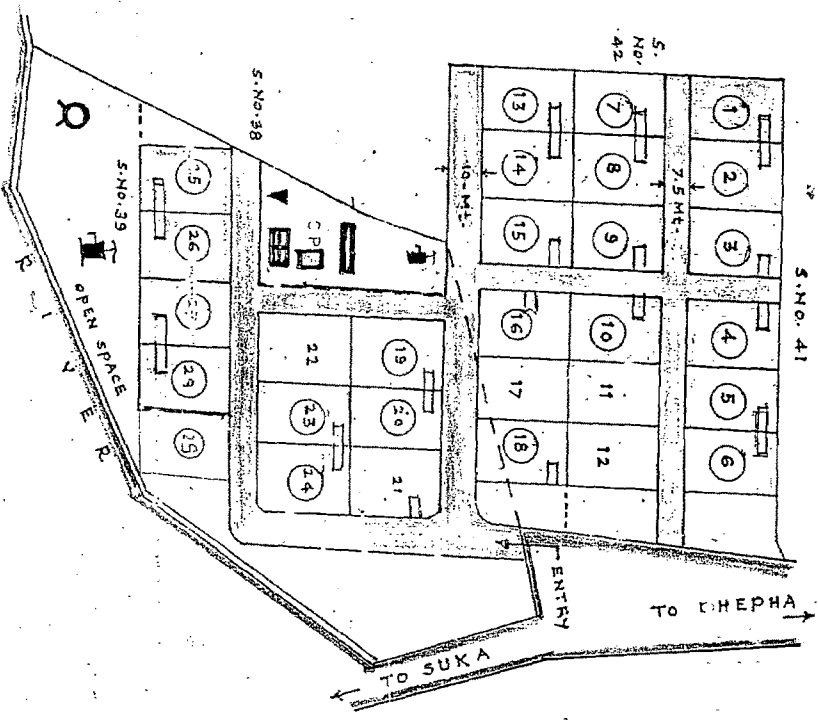

PLOTS ALLOTTED	PLOTS AVAILABLE	RESIDENTIAL PLOTS TO MAKE AVAILABLE FROM ADJOINING LAND
35	4	

AREA TABLE	
SR. NO.	PARTICULAR
1	RESIDENTIAL PLOT AREA
2	AREA OF ROAD
3	COMMON PLOT AREA
4	UNUSE LAND AREA
	TOTAL AREA

JAYD R SARGVAE PUNAYASAT AGENCY

LAY OUT PLAN FOR RES. SITE AT VANKU VASANA. TA. NASWADI DIST. VADODARA NARMADA PROJ. CONST. (REH) DN-1 K. COLONY

DY. EX. ENGR. *[Signature]* SPT. ENGR. *[Signature]*

DRAWN BY *[Signature]* TRACED BY *[Signature]*

CHECKED BY *[Signature]* COMP. BY *[Signature]*

SCALE: DRG. NO. 339 DT. 28/11/98

PLOTS ALLOTTED	PLOTS AVAILABLE	RESIDENTIAL PLOTS TO MAKE AVAILABLE FROM ADJOINING
AGRI RESI	AGRI RESI	LAND
84	6	

S.NO.10

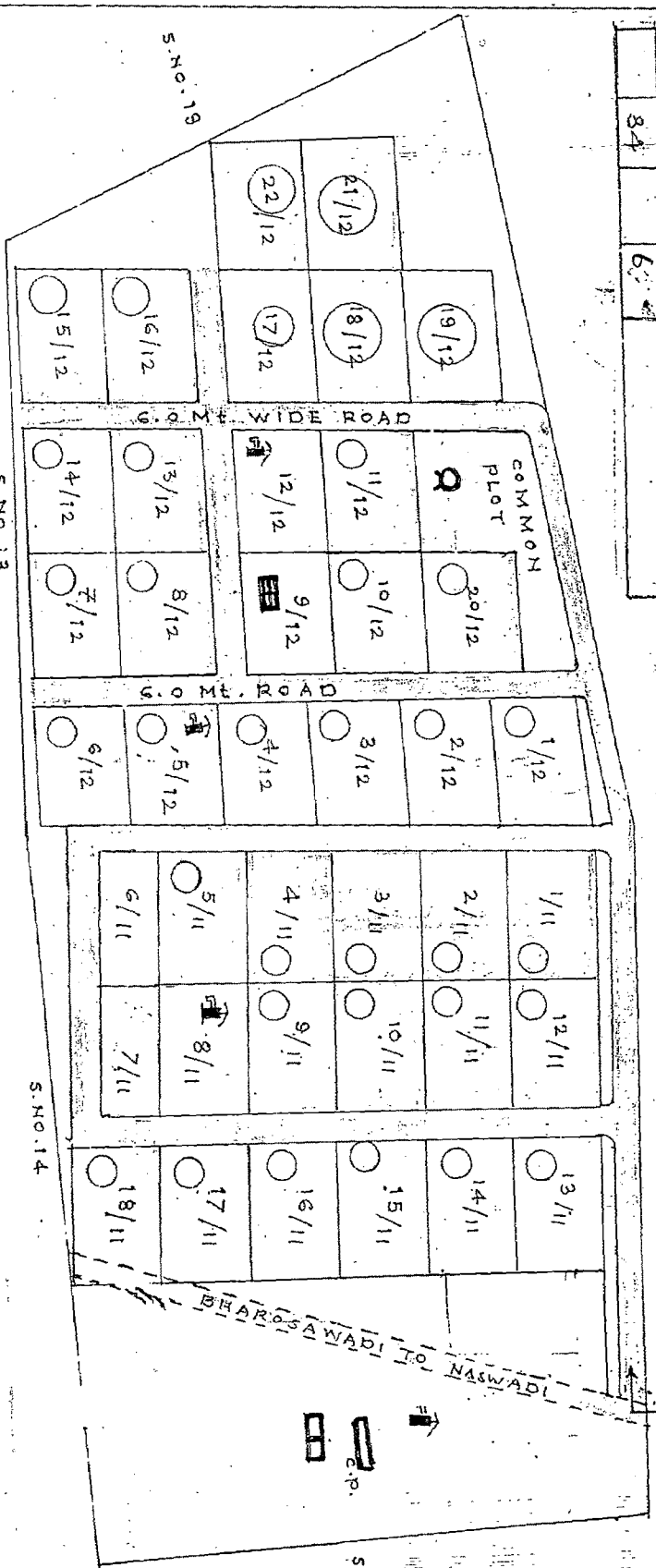
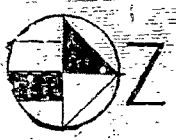

S.NO.13

### LAY OUT PLAN S.NO.11-12

S.NO.14

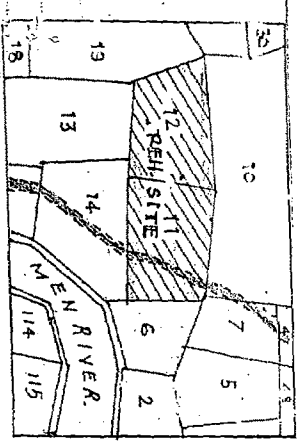

### KEY PLAN

NO.	QUANTITIES	NO.	PROVIDED	STANDARD
1. RES. PLOTS REGR. AVAILABLE	6.3	34		
2. (a) 150mm DIA. SOD. WELL WITH HAND OPERATED WATER LIFTING DEVICE	1			
(b) 150mm DIA. SOD. WELL WITH HAND OPERATED WATER LIFTING DEVICE	4			
(c) PIPE LINE 150/100mm DIA. SOD. WITH MECHANICAL WATER LIFTING DEVICES WITH PIPE LINE 90/65 mm DIA. TOTAL LENGTH WITH STAND PIPES	1			
3. PRIMARY SCHOOL (2.160/0.160)	1			
4. SITTING PLATFORM	1			
5. APPROACH ROAD	0.15 km			
6. INTERNAL ROAD	0.5 km			
7. CHRISTIAN PARK	1			
8. PLAY GROUND	1			
9. CORE HOUSE	36			
10. DISPENSARY				

SARDAR SAROVAR PUNARVASVAT AGENCY

LAY OUT PLAN FOR REH. SITE AT KOLU TAL. NASWADI DIST. VADODARA

N.P.CONST.(REH)DN.NO.2 K'COLONY.





BY EX. ENGR.	EX. ENGR.	SUPD. ENGR.
DRAWN BY	TRACED BY	
CHECKED BY	COMP BY	
SCALE	DRS. NO.	DT. 4/2/2002





# KEY SITE PLAN



REFERENCE WITH AREA TABLE			
Total Area of Land Acquired		28500 S/ft	
1	R.S. No	731, 732, 733, 734	
2	Total Area of Land	28500 MT.	
3	Total No. of Pkts	42 NOS	
4	Total Area of Pkts	19152=00	
5	Size & Area of Pkts	As Shown 500 sq mt	
6	Core House Consiged	38 NOS	
Sr.	Amenities	Pro	Symbol
No.		Provided	
1	Road Pkts ..Rearv	42	
2	Road Pkts ..Abosed	38	
3	Road Pkts ..Vasent	04	
4	Core House Abosied	38 NOS	
5	Core House Available	Nos	
6	Open Well	NO	0
7	Hand Pump/Food Well	2	0/0
8	Primary School (2 Room)	1	NO
9	Madhyam Bhojan		
10	Umlal (Ls)	NO	0
11	Tree Platform	1	NO
12	Children Park	1	NO
13	Internal Road	1	50MT
14	Play Ground	1	NO
15	11 Sweds	2	NO
16	11 Sppary	1	NO
17	Pipe (Landstand Post)	380MT	
18	Over Head (Oh) Tank	1	NO
19	Over Head (Oh) Tank	1	NO
20	Low Level Tank (Slump)	1	NO
21	16		

SARDA SAROVAR PURNAPASVATI AGENCY  
N.P. CONST. (REH) CIRCLE NO. 2 VADODARA.  
N.P. REH U.D.H. NO. 15 VADODARA  
LAY OUT PLAN FOR REH. RESIDENTIAL PLOT  
VILLAGE :- VA DADAT-2  
TALUKA :- DABHOI DIST :- VADODARA

BY EX. ENGR. SUPDGT. ENGR.  
DRAWN BY CHECKED BY  
TRACED BY COMPADE BY

DATE 3.12.2002 DRG NO. UPRIKUL/5

## KEY PLAN

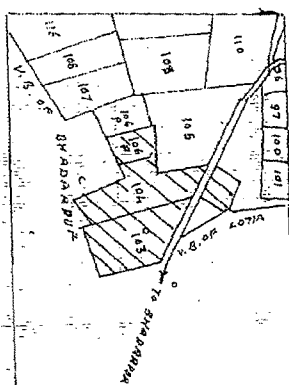

## REFERENCE

1	AREA OF LAND ACQUIRED/S.NO	103, 104, 105, 106
2	TOTAL NO OF PLOTS/AREA	103
3	SIZE & AREA OF PLOT	18.00 x 28.00
4	AREA OCCUPIED BY ROAD	
5	AREA OF COMMON PLOTS/O.S.	
6	HAND PUMP WITH HAWADA	
7	WELL/PIPE LINE	1/0
8	TREE PLATFORM	2 NOS
9	SCHOOL	1 NO
10	URINAL	1 NO

SARDAR SAROVAR PUNARVASI AGENCY

LAY OUT PLAN FOR REH. SITE  
AT: GOLAGAMDI TAL: SANKHECH  
DIST: VADDARA

NARMADA PROJ. CONST. (REH) DN-2, K COLONY

DY. EX. ENGR.	EX. ENGR.	SUPD.G. ENGR.
DRAWN BY:	TRACED BY: K. K. DARJI	
CHECKED BY: J. S. D. D.	COMP BY:	
SCALE:	DRG. NO.	DT: 26-9-96

## AREA TABLE

S.NO.	PARTICULAR	AREA
1	RESIDENTIAL PLOT AREA	5-19-12
2	AREA OF ROAD	1-68-42
3	COMMON PLOT/O.S. AREA	1-52-83
4	UNUSE LAND AREA	-
	TOTAL AREA	8-40-37

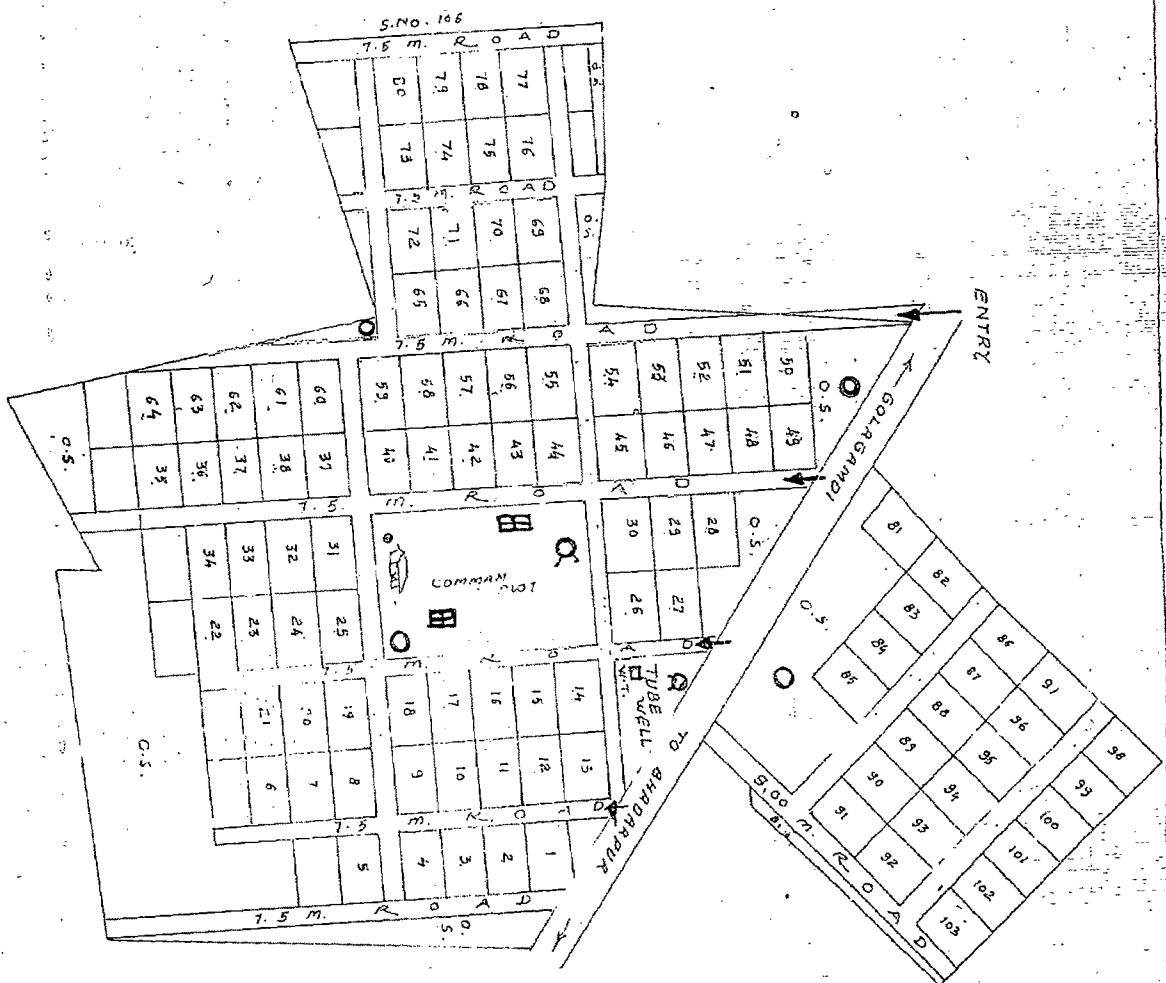

મોજે:- શિવલેરનોડ  
 વા. સભાઈ  
 બી. વડોદરા.

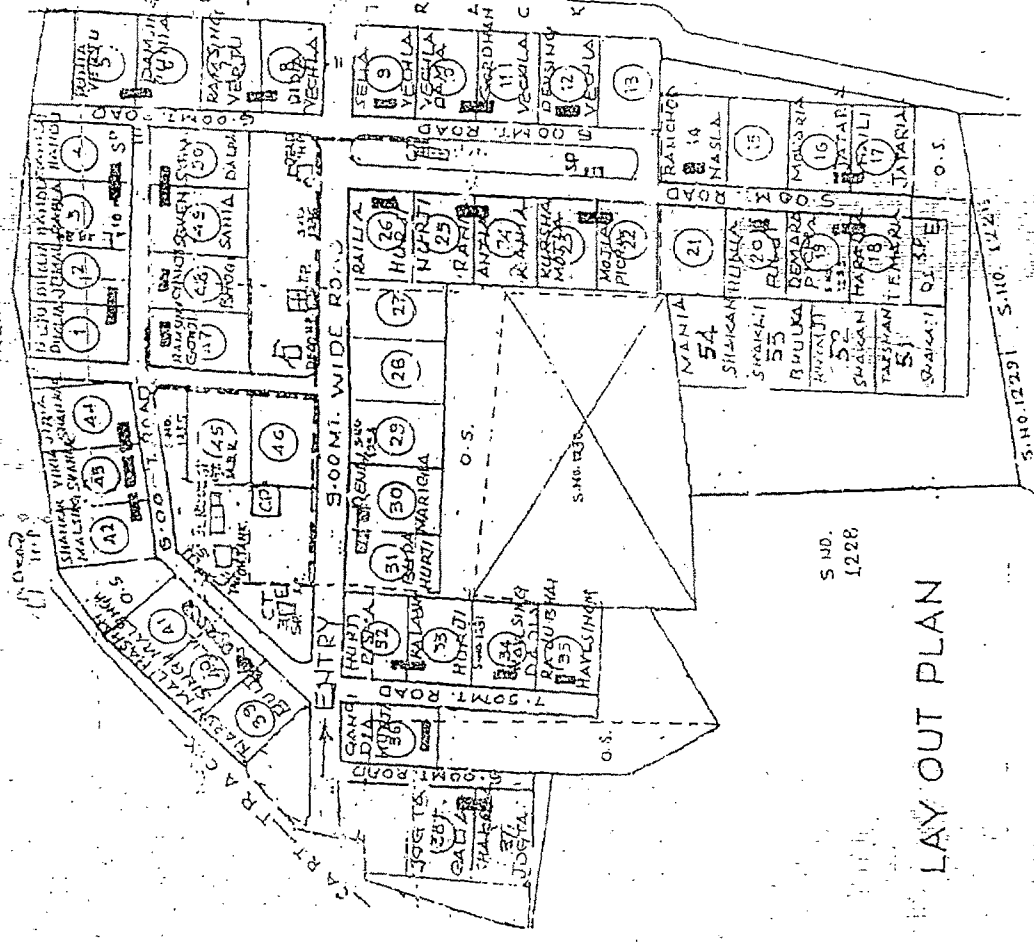
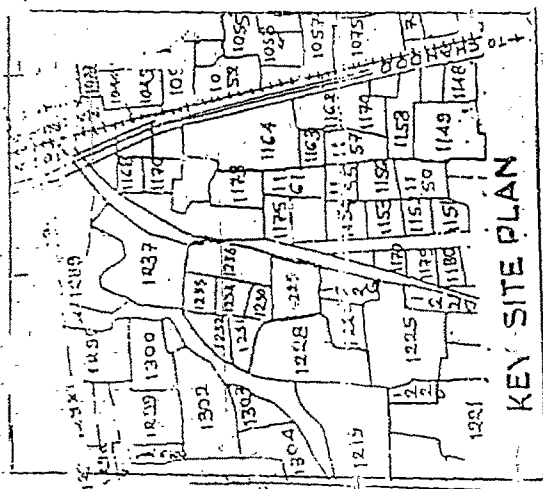

LAY OUT PLAN

S. NO. 1228

RESSETTLEMENT PLAN AT: DABHOI TA: DABHOI  
 ING CELL S.S. N. L. C

REFERENCE WITH AREA TABLE		519.55 Smt.	
1	Total Area of Land Acquired	519.55 Smt.	519.55 Smt.
2	Total Area of Land	519.55 Smt.	519.55 Smt.
3	Total No. of Plots	42	42
4	Total Area of Plots	504.00 m <sup>2</sup>	504.00 m <sup>2</sup>
5	Size & Area of Plots	42 NOS	42 NOS
6	Core House Constructed	42 NOS	42 NOS
Sr. Amenities		No. Provided	
1	Rest. Plots - Ready	42 NOS	42 NOS
2	Rest. Plots - Vacant	42 NOS	42 NOS
3	Core House Available	1 NO	1 NO
4	Open Well	3 NOS	3 NOS
5	Hand Pump	1 NO	1 NO
6	Primary School (2 Room)	1 NO	1 NO
7	Madhyam Bhogian	1 NO	1 NO
8	Urinal (urb)	1 NO	1 NO
9	Tree Platform	1 NO	1 NO
10	Children Park	1 NO	1 NO
11	Internal Road	0.5 km	0.5 km
12	Play Ground	1 NO	1 NO
13	Hewada	2 NOS	2 NOS
14	Dispensary	1 NO	1 NO
15	Rice Line/Sand Post	1 NO	1 NO
16	Over Head (O.H.) Tank	1 NO	1 NO
17	Low Level Tank (Lump)	1 NO	1 NO

SARDAAR SAROVAR PUJARI/VASAT AGENCY  
 N.P. CONST. (RE) CIRCLE NO. 1, VADODARA.  
 H.P. (RE) LIDH. NO. 5, VADODARA.  
 LAY OUT PLAN FOR REH. RESIDENTIAL PLOT  
 VILLAGE: DABHOI - SINOR ROAD-1  
 TALUKA: DABHOI DIST. VADODARA  
 BY EX. ENGR. EX. ENGR. SUPDNG. ENGR.  
 DRAWN BY. CHECKED BY  
 TRACED BY. COMPARE BY  
 DATE: / / 1900 Dwg. No. 1111/1111